

PROCESS TO CALIBRATE THE GRINDER

A

Necessary equipment



1 → Gauge Block KO-CY1014

B

Defective part

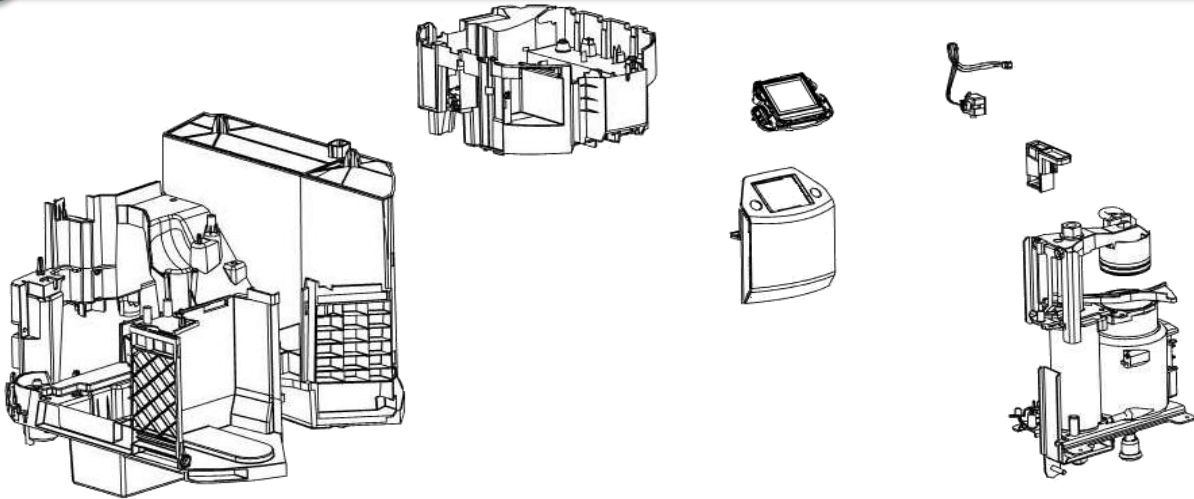

C

Process of calibration

1



2



3



In 3 sec. MAX

4



5

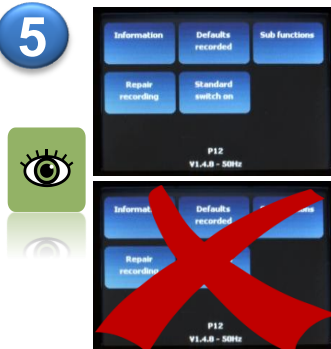

6

Restart the process

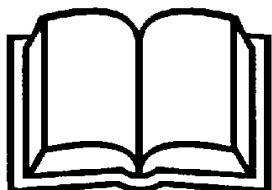

EA9000../70.

30/01/2013

BARISTA

1/2

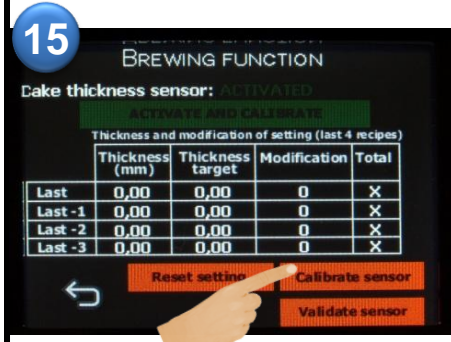
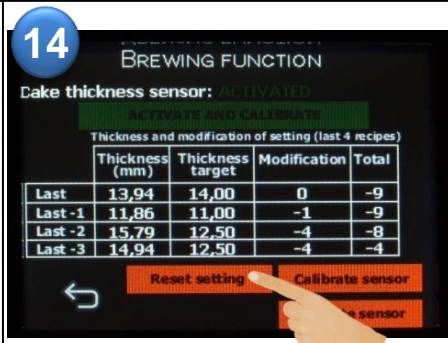
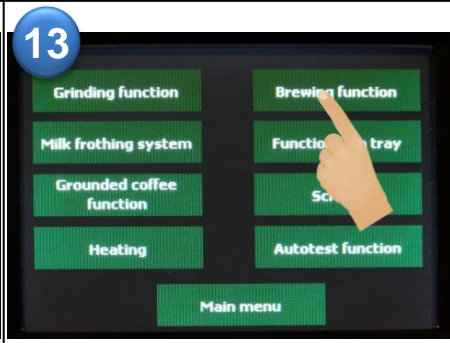
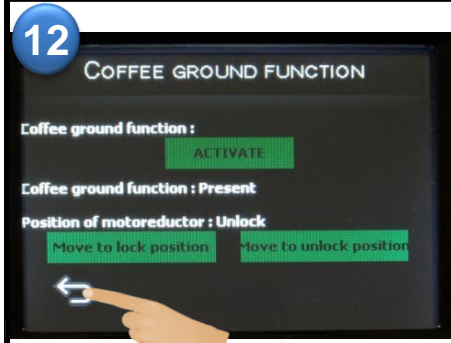
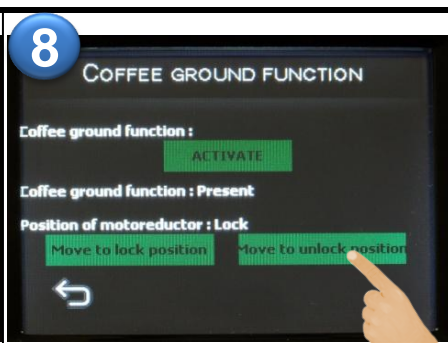
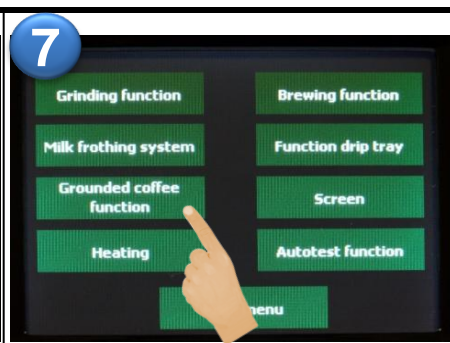
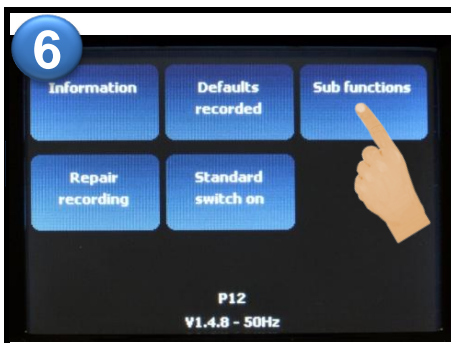

Process in progress ...

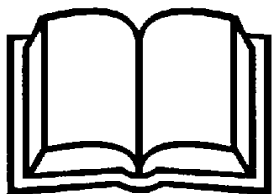
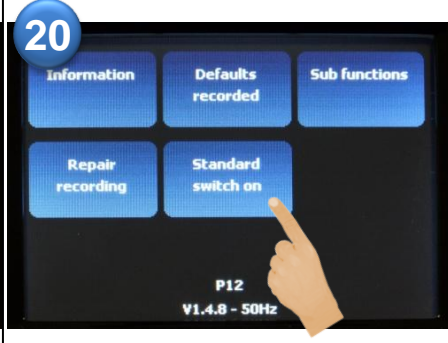
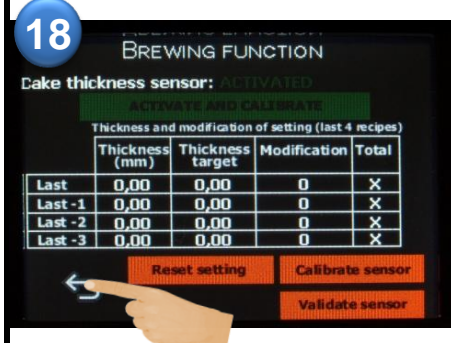

EA9000../70.

30/01/2013

BARISTA

2/2