

Tefal®

EN

Ultimate Pure



www.tefal.co.uk



SUMMARY

IMPORTANT SAFETY RECOMMENDATIONS

Important safety recommendations.....	p. 5
Before first use.....	p. 8

PREPARATION

Which water should I use?.....	p. 9
Filling the water tank.....	p. 9

USE

Adjusting the temperature and steam.....	p. 10
Dry ironing.....	p. 11
Getting more steam : turbo boost.....	p. 11
Getting more steam : extra steam.....	p. 12
Vertical steam ironing.....	p. 12
Dampening clothing (Spray).....	p. 14
While ironing.....	p. 14
Auto-Off Function.....	p. 14

IRON STORAGE AND MAINTENANCE

Storing your iron.....	p. 15
Cleaning the Micro Calc filter.....	p. 16
Cleaning the anti-calc valve (once per month).....	p. 18
Cleaning the soleplate.....	p. 19

IS THERE A PROBLEM WITH YOUR IRON?

Problems, possible causes, solutions.....	p. 20-21
---	----------

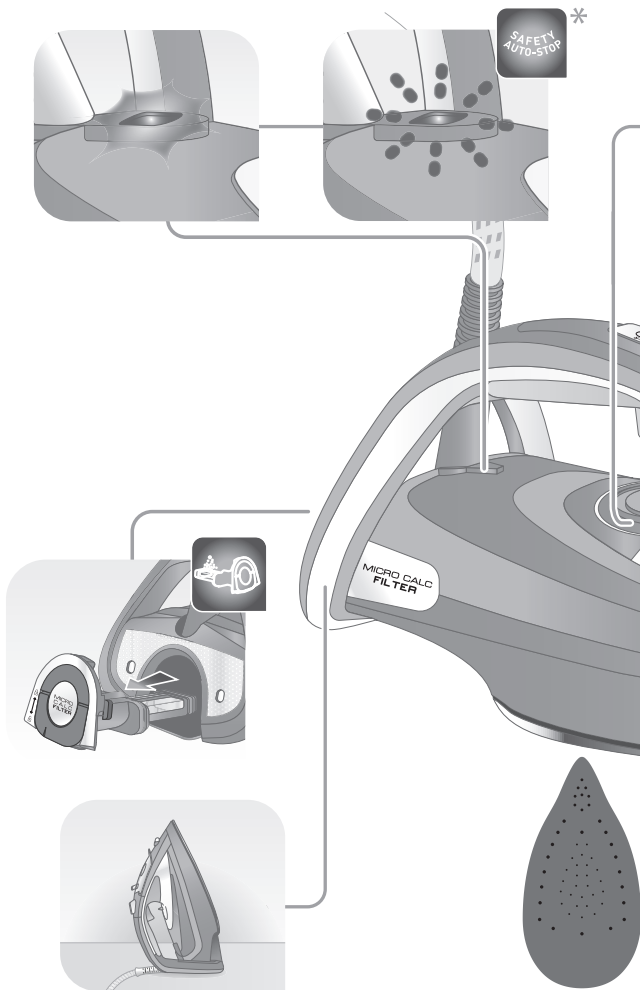

* EN Depending on model

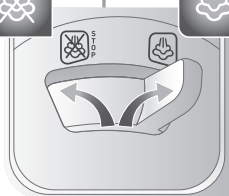
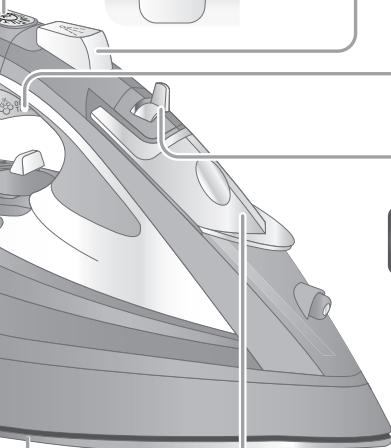
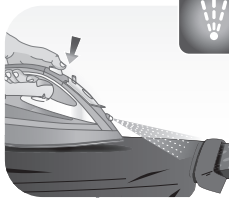
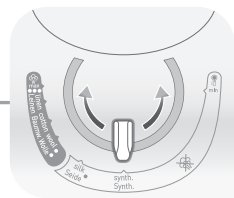

*



*

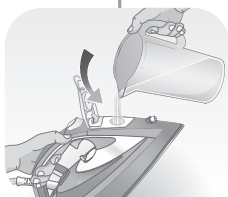

www.tefal.co.uk



IMPORTANT SAFETY INSTRUCTIONS

- Please read these instructions carefully before first use. This appliance has been designed for domestic and indoor use only. Any commercial use, inappropriate use or failure to comply with the instructions, the manufacturer accepts no responsibility and the guarantee will not apply.
- Never unplug the appliance by pulling the power cord. Always unplug your appliance: before filling the water tank or rinsing the water tank, before cleaning the appliance and after each use.
- The appliance must be used and placed on a flat, stable, heat and water resistant surface. When you place the iron on the iron rest, make sure that the surface on which you place it is stable.
- This appliance is not intended to be used by persons (including children) with reduced physical, sensory or mental capabilities or persons lacking appropriate knowledge or experience, unless a person responsible for their safety provides either supervision or appropriate instructions concerning use of the appliance prior to its use.
- Children should be supervised to ensure they do not play with the appliance.
- This appliance may be used by children aged 8 or over and persons lacking appropriate knowledge or experience or persons with reduced physical, sensory or mental capabilities provided that they

have been thoroughly instructed regarding use of the appliance, are supervised, and understand the risks involved. Children shall not play with the appliance. Cleaning and user maintenance shall not be made by children without supervision. Keep the iron and its cord out of reach of children less than 8 years of age when it is in use until it has cooled down completely.



- The surfaces of your appliance can reach very high temperatures when functioning, which may cause burns. Do not touch the hot surfaces of the appliance (accessible metal parts and plastic parts adjacent to the metallic parts).
- Never leave the appliance unattended when it is connected to the mains. Before storing the appliance, once it is unplugged, please wait until it has cooled down completely (around 1 hour).
- The appliance must not be used if it has been dropped, if it has any visible damage, if it leaks, or if it functions abnormally in any way. Do not attempt to dismantle your appliance: have it examined at an Approved Service Centre to avoid any danger.
- The iron should only be used with the base provided (for cordless irons).

- Check the electrical power cord for signs of wear or damage prior to use. If the electrical power cord is damaged, please contact an Approved Service Centre to avoid any danger.

- The iron must always be placed on its base and never on its heel (for cordless irons) .
- Your iron and its base must be used and placed on a flat, stable, heat-resistant surface. When you place the iron on its base, ensure that the surface on which the base is placed is stable.
- For your safety, this appliance conforms to all applicable regulations (Low Voltage Directive, Electromagnetic Compatibility, Environment, etc).
- Your steam iron is an electrical appliance: it must be used under normal conditions of use. It is designed for domestic use only.
- Always plug your steam iron:
 - into a mains circuit with voltage between 220 V and 240 V,
 - into an earthed electrical socket.Connecting to the wrong voltage may cause irreparable damage to the appliance and will invalidate your guarantee.

- Do not use an extension lead. If you accept liability for doing so, only use an extension lead which is in good condition, has a plug with an earth connection and is suited to the power rating of the appliance.
- Completely unwind the power cord before plugging into an earthed socket.
- The soleplate of your iron can reach extremely high temperatures, and can cause burns: do not touch them. Never touch the electrical power cords with the soleplate of the iron.
- Do not leave the power cord close to or in contact with sources of heat or sharp edges.
- Your appliance emits steam, which can cause burns. Always handle the iron with care, especially when ironing vertically. Never direct the steam towards people or animals.
- Never immerse your steam iron in water or any other liquid. Never place it under a running tap.
- The plug must be removed from the socket-outlet before the water tank is filled with water.

PLEASE RETAIN THIS INSTRUCTION BOOKLET FOR FUTURE REFERENCE



Environment protection first !

- ① Your appliance contains valuable materials which can be recovered or recycled.
- ➡ Leave it at a local civic waste collection point.

BEFORE FIRST USE



Remove any labels from the soleplate before heating the iron.

Before using the steam function in your iron for the first time, we recommend that you allow the iron to operate a few moments in a horizontal position without coming into contact with your laundry. Keeping the iron in this position, push the steam button several times.

During the first few uses, the appliance may produce smoke, a harmless odour and a light emission of particles. These are simply the engineering residues from the manufacturing process burning off. These are harmless and will quickly disappear.

Important notice for $\geq 3000\text{W}$ models only:

Under unfavourable mains conditions, phenomena like transient voltage drops or lighting fluctuations can happen. Therefore, it is recommended that the iron is connected to a power supply system with a maximum impedance of $0.29\ \Omega$. If necessary, the user can ask the public power supply company for the system impedance at the interface point.

PREPARATION

Which water should I use?

- Your appliance was designed to operate using untreated tap water.
- Do not use pure demineralised or pure distilled water, water from clothes dryers, scented or softened water, or water containing additives (starch, perfume, aromatic substances, softeners, etc.), rain water, filtered, bottled or boiled water, water from refrigerators, batteries or air conditioners. These types of water contain organic waste, mineral elements that become concentrated when heated and cause spitting, brown staining, leaking or premature wear on your iron.



If your water is very hard (above 30°F or 17°dH or 21°e) mix 50% untreated tap water with 50% distilled water (available in hardware stores).

*

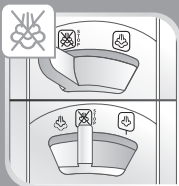

* Depending on model



Filling the water tank

- Unplug the iron before filling it.
- Set the steam control to .
- Lift the iron and, holding it at a slight incline, point the soleplate up.
- Open the water tank cover.
- Fill the water tank to the mark “Max”.
- Close the water tank cover.



Warning ! Do not fill your iron through the filter opening. Do not remove the Micro Calc filter to fill the tank.

USE



- Plug in the appliance.



* Depending on model

Adjusting the temperature and steam

- Set the steam control to 
- Adjust the temperature control, referring to the table below.

FABRIC	TEMPERATURE CONTROL POSITION
LINEN / COTTON	Max
WOOL	• •
SILK	•
SYNTHETIC (Polyester, Acetate, Acrylic, Polyamide)	•

 = STEAM ZONE

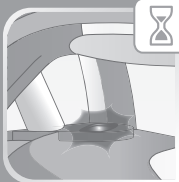

- The temperature indicator light turns on.



- It will turn off automatically once the soleplate achieves the desired temperature.

Set the temperature control dial to match the type of fabric you wish to iron. Your iron automatically and accurately determines the ideal temperature and steam flow.

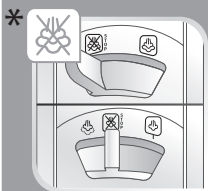

* Depending on model

Dry ironing

- Set the steam control to 
- You may continue to iron when the indicator light turns off.



Getting more steam : turbo boost

- Set the thermostat control to “•••”.
- Note: This setting is only suitable for cotton and linen.

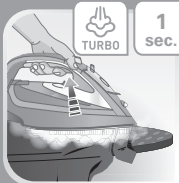

- Press the turbo steam button periodically (turbo steam).
- To avoid water dripping on the laundry, maintain an interval of a few seconds in between each press.

Getting more steam : extra steam



- Set the thermostat control to “•••”.
- Note: This setting is only suitable for cotton and linen.



- Set the steam control to .
- Push and hold the steam button.



- Keep holding and iron
- To avoid water dripping on the laundry, do not use extra steam continuously.



Vertical steam ironing

- Hang the item on a hanger and keep the fabric taut with one hand. The steam is very hot; never steam iron clothing while it is being worn—always use a hanger.



- Set the thermostat control to “•••”.

* Depending on model



- Press the turbo steam button (turbo steam) 1 second, moving the iron from top to bottom.



- Hold the iron at a distance of a few centimetres from the clothing to avoid burning delicate fabrics.



- After pressing the turbo boost trigger 3 times, put the iron back in the horizontal position and start again.

Dampening clothing (Spray)



- When dry or steam ironing, press repeatedly on the spray button to moisten clothing and remove stubborn creases.
- Ensure that there is water in the tank before using the spray button.

NO



OK



While ironing

- Do not lay the iron down on the soleplate; use the heel rest for this purpose.

Auto-Off Function



- If the iron remains unused for more than 8 minutes on the heel rest or more than 30 seconds laid flat or on its side, the electronic system will cut the power, the iron will stop heating **and the temperature indicator light will begin to flash.**
- To restart the iron, move it gently until the indicator stops flashing.

IRON STORAGE AND MAINTENANCE

Storing your iron

- Unplug the iron and wait for the soleplate to cool completely (approx. 1 hour).



- Empty the water tank.



- Set the steam control to .

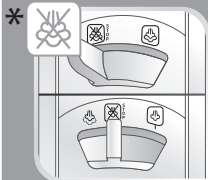

* Depending on model

- Wrap the cord around the heel of the iron. Store the iron on its heel rest.

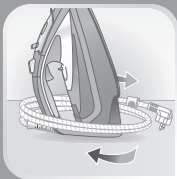

Cleaning the Micro Calc filter



- When the clean filter alert turns on, finish your ironing session and switch off the appliance.



- Unplug the iron, empty the water tank and wait for the soleplate to cool down completely (approx. 1 hour).



- Once the steam iron has completely cooled down, raise and turn the tab of the Micro Calc filter to unlock it.



- Remove the Micro Calc filter from the iron, it contains the limescale collected in the iron.



- Throw the scale particles trapped in the filter away.



- To descale the Micro Calc filter thoroughly rinse it in diluted citric acid for 2 hours.



- Rinse it with tap water



- Reposition the Micro Calc filter in its housing and turn the tab a quarter turn to the right in order to lock the filter and ensure it is watertight.



- Plug in and switch on the iron and reset the clean filter alert by pressing the clean filter button.



- **Warning!** Never use the iron without the Micro Calc filter.

Cleaning the anti-scale valve (once per month)



- Unplug your iron and empty the water tank.



- To remove the anti-calc valve, open the water tank cover and pull on the valve near the steam control.



- Soak the valve for 4 hours in a glass of water with diluted citric acid.



- Rinse the valve under the tap.



- Insert the valve in place, pushing it until you hear a click.



Beware!
Never touch the end of the valve.
The iron will not function without the anti-calc valve.

Cleaning the soleplate



- Unplug your iron and, once completely cooled, wipe it with a soft cloth.



- Never use chemical or abrasive products.

IS THERE A PROBLEM WITH YOUR IRON?

PROBLEMS	POSSIBLE CAUSES	SOLUTIONS
Water is leaking from the holes in the soleplate.	You are using the steam when the iron is not hot enough.	Wait for the indicator light to turn off.
	You are using the turbo steam button (turbo steam) too often.	Wait a few seconds between each use.
	You are using the extra steam button too often	Do not use extra steam continuously.
	You have stored the iron horizontally without emptying the water tank or setting the steam control to ☒.	See the chapter on «Storing your iron».
The iron leaks at the start of ironing.	You have removed the Micro Calc filter to fill up your iron	Do not remove the Micro Calc filter when filling the iron.
	The steam control dial is not set to ☒ when filling the water tank.	Ensure that the steam control dial is set to ☒ when filling the water tank.
A brown discharge coming from the soleplate is staining the clothing.	You are using chemical descaling agents.	Do not introduce a descaling agent into the water tank.
	You are not using the right type of water.	See the chapter on «What water should I use?»
	Clothing fibres are building up in the holes of the soleplate and burning.	Clean the soleplate with a damp sponge. Periodically vacuum the holes in the soleplate.
The soleplate is dirty or brown and may stain clothing.	You are using starch.	Clean the soleplate as indicated above. Spray the starch on the reverse side of the clothing to be ironed.
	Your laundry has not been rinsed sufficiently or you are ironing a new item of clothing before washing it.	Ensure that your laundry is sufficiently rinsed to eliminate potential soap deposits or chemical products on new items of clothing.

IS THERE A PROBLEM WITH YOUR IRON?

PROBLEMS	POSSIBLE CAUSES	SOLUTIONS
Your iron produces little to no steam.	The water tank is empty.	Fill up the water tank.
	The anti-calc valve is dirty.	Clean the anti-calc valve.
	Your iron is clogged up with limescale.	Clean the anti-calc valve and the Micro Calc filter.
	The Micro Calc filter is dirty.	Clean the Micro Calc filter.
The soleplate is scratched or damaged.	You have placed your iron on a metallic iron rest or ironed over metal zips or fasteners.	Always place your iron on its heel rest when not in use. Do not iron over metal zips or fasteners
The iron steams once the water tank has been filled.	The steam control dial is not set to ☒.	Ensure that the steam control dial is set to ☒.
	The water tank is too full.	Do not exceed the max level for filling.
The spray does not spray water.	The water tank is not full enough.	Add water to the water tank.
The clean filter alert does not turn off after the Micro-Calc filter cleaning	You did not reset the clean filter alert	Press on the clean filter alert

If you have any problems or queries please call our Customer Relations team first for expert help and advice.

See Helpline number in the separate guarantee and country list leaflet.

www.tefal.co.uk

