

Rowenta | Tefal

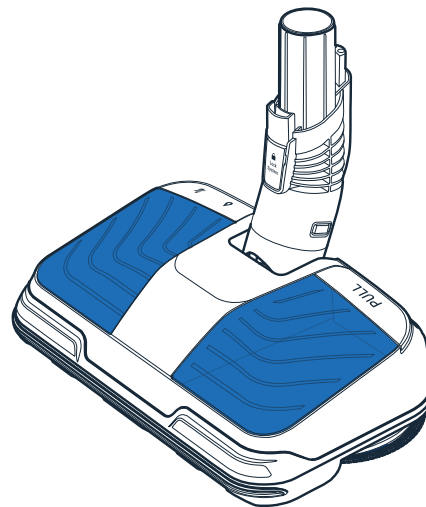

AEROSPIN AQUA HEAD



INSTRUCTIONS FOR USE

FR GUIDE DE L'UTILISATEUR / EN USER'S GUIDE / DE BEDIENUNGSANLEITUNG / NL GEBRUIKSAANWIJZING / ES GUIA DEL USUARIO / PT GUIA DE UTILIZACAO / IT ANUALE D'USO / EL ΟΔΗΓΟΣ ΧΡΗΣΗΣ / TR KULLANIM KILAVUZU / CS NAVOD K POUŽITÍ / SK POUŽIVATELSKA PRÍRUČKA / HU HASZNALATI UTMUTATO / PL INSTRUKCJA OBSŁUGI / ET KASUTUSJUHEND / LT NAUDOTOJŲ VADOVAS / LV LIETOŠANAS PAMĀCĪBA / BG РЪКОВОДСТВО НА ПОТРЕБИТЕЛЯ / RO GHIDUL UTILIZATORULUI / SL NAVODILA ZA UPORABNIKA / HR RUTE ZA UPORABU / BS RUTE ZA UPOTREBU / SR UPUTSTVO ZA UPOTREBU / RU РУКОВОДСТВО ПОЛЬЗОВАТЕЛЯ / UK ПОСІБНИК КОРИСТУВАЧА / ZH 用户指南 / KO 사용자 가이드 / TH คำแนะนำในการใช้งาน / VI HƯỚNG DẪN SỬ DỤNG / AR لَامْعْتَسَالَا لِيَلْد / FA ریدراک یاجنهار / FI KAYTTOOPPA NO BRUKERMANUAL / DK BRUGER MANUAL / SE BRUGER MANUAL / MS PANDUAN PENGGUNAA

ONLY FOR/SEULEMENT POUR X-FORCE 12.60 NEO & 13.60 RH9A/9L & TY9A & E09A

NOT COMPATIBLE X-FORCE 8.60 (RH96/TY96/E096), X-FORCE 9.60 (RH20/TY20/E020), X-FORCE 12.60 (RH98/TY98/E098), X-FORCE 14.60 (RH99/TY99/E099), X-FORCE 15.60 (RH99/TY99/E099), X-PERT 6.60 (RH64/TY64/E064/RH68/TY68/E068)

PLEASE READ CAREFULLY

THE “SAFETY AND USE INSTRUCTIONS” BOOKLET BEFORE FIRST USE

FR Veuillez lire attentivement le livret “Consignes de sécurité et d'utilisation” avant la première utilisation / **DE** Lesen Sie vor dem erstmaligen Gebrauch aufmerksam die Broschüre „Sicherheits- und Bedienungshinweise“ durch / **NL** Gelieve vóór het eerste gebruik aandachtig het boekje met de veiligheids- en gebruiksvorschriften door te nemen / **ES** Lea detenidamente el libro «Instrucciones de seguridad y de uso» antes de utilizar el aparato por primera vez / **PT** Leia atentamente o manual «Instruções de segurança e utilização» antes da primeira utilização / **IT** Leggere con attenzione il libretto “Norme di sicurezza e d'uso” al primo utilizzo / **EL** Διαβάστε προσεκτικά το εγχειρίδιο «Οδηγίες ασφαλείας και χρήσης» πριν από την πρώτη χρήση / **TR** İlk kullanımdan önce “Güvenlik ve kullanım talimatları” kitapçığını dikkatlice okuyun / **CS** Před prvním použitím si, prosím, pečlivě prostudujte „Bezpečnostní pokyny pro použití“ / **SK** Pred prvým použitím si pozorne prečítajte „Bezpečnostné odporúčania a použitie“ / **HU** Az első használat előtt figyelmesen olvassa el a „Biztonsági előírások és használati útmutató” című fejezetet / **PL** Przed pierwszym użyciem proszę uważnie przeczytać broszurę „Zalecenia dotyczące bezpieczeństwa i użytkowania” / **ET** Palun lugege enne esimest korda kasutamist hoolikalt ohutus- ja kasutusjuhendit / **LT** Atidžiai perskaitykite knygelę „Saugos ir naudojimo reikalavimai” prieš naudodami įrenginį pirmą kartą / **LV** Pirms izmantojāt ierīci pirmoreiz, lūdzu rūpīgi izlasiet brošūru “Norādījumi par drošību un lietošanu” / **BG** Моля, прочетете внимателно книжката “Препоръки за безопасност и употреба” преди първоначална употреба / **RO** Înainte de prima utilizare, citiți cu atenție manualul „Instrucțiuni de siguranță și de utilizare” / **SL** Pred prvo uporabo natančno preberite »Navodila za varno uporabo« / **HR** Molimo da prije prve uporabe pažljivo pročitate priručnik „Sigurnosne upute” / **BS** Prije prve upotrebe pažljivo pročitaite knjižicu “Sigurnosne upute” / **SR** Pre prve upotrebe, pažljivo pročitaite “Bezbednosno l uputstvo za upotrebu” / **RU** Перед первым использованием внимательно прочитайте инструкцию «Меры безопасности и правила использования» / **UK** Перед першим використанням уважно прочитайте посібник «Правила техніки безпеки та рекомендації щодо використання» / **ZH** 请在初次使用本产品前仔细阅读“安全及使用说明” / **KO** 제품을 처음 사용하기 전에 “안전 주의사항과 사용 방법”에 대한 안내 책자를 주의 깊게 읽으시기 바랍니다 / **TH** โปรดอ่านคู่มือ “คำแนะนำด้านความปลอดภัยและการใช้ งาน” อย่างละเอียดก่อนเริ่มการใช้งาน / **FA** ی لطوآلا قزولال لامعتسالال لببق ،قی آنعب «لامعتسالال تاداشر او ةمالسدا ببيتك» ةبارق ی چونی / **VI** Vui lòng đọc kỹ tập sách nhỏ “hướng dẫn sử dụng và an toàn” trước khi sử dụng lần đầu tiên / **AR** Les nøyegjenom brosjyren «Sikkerhets- og bruksanvisning» før du bruker den / **DK** Læs omhyggeligt bogen «Sikkerheds- og brugsanvisning» inden første brug / **SE** Läs noga igenom broschyren «Säkerhets- och användningsinstruktioner» innan du använder den första gången / **MS** Sila baca buku arahan keselamatan tengal teliti sebelum penggunaan pertama

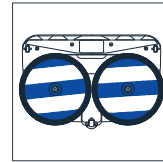
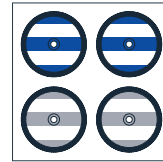
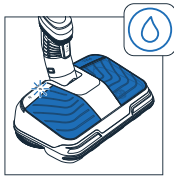
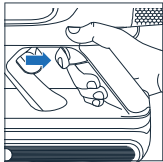
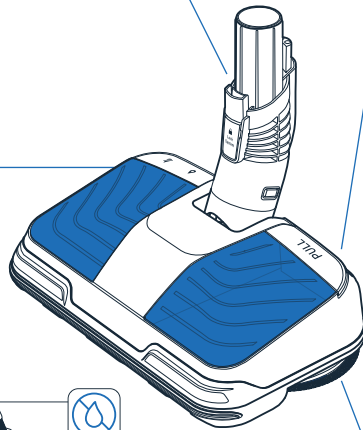
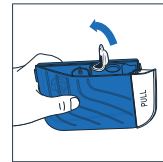
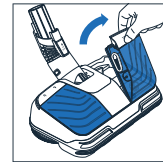
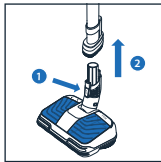

ZR009503

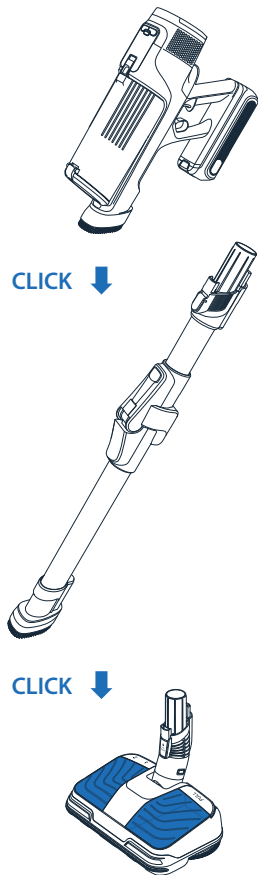

WOOD*

FR BOIS / DE HOLZ / NL HOUT / ES MADERA / PT MADEIRA / IT LEGNO / EL ΞΥΛΟ / TR AHŞAP / CS DŘEVO / SK DREVO / HU FA / PL DREWNO / ET PUIT / LT MEDIS / LV KOKS / BG ДЪРВО / RO LEMN / SL LES / HR DRVO / BS DRVO / SR DRVO / RU ПАРКЕТ / UK ДЕРЕВИНА / ZH 木质 / KO 목재 / TH ไม้ / VI GỖ / AR الخشب / FA چوب / FI PUU / NO WOOD / DK TRÆ / SE TRÄ / MS KAYU

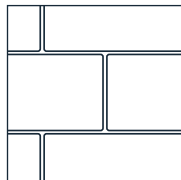

TILE*

FR CARRELAGE / DE FLIESEN / NL TEGEL / ES AZULEJO / PT MOSAICOS / IT PIASTRELLE / EL ΠΛΑΚΑΚΙ / TR FAYANS / CS DLAŽDICE / SK DLAŽBA / HU CSEMPE / PL KAFELKI / ET PLAADID / LT PLYTELĖS / LV FLĪZES / BG ПЛОЧКИ / ROGRESIE / SLPLOŠČICE / HRPLOČICE / BSPLOČICE / SRPLOČICE / RU ПЛИТКА / UK ПЛИТКА / ZH 瓷砖 / KO 타일 / TH กระเบื้อง / VI GẠCH MEN / AR البلاط / FA کاشی / FI LAATTA / NO TILE / DK FLISE / SE KAKEL / MS JUBIN

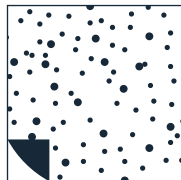

LINOLEUM*

FR LINOLÉUM / DE LINOLEUM / NL LINOLEUM / ES LINÓLEO / PT LINÓLEO / IT LINOLEUM / EL ΛΙΝΟΤΑΠΗΤΑΣ / TR MUŞAMBA / CS LINOLEUM / SK LINOLEUM / HU LINÓLEUM / PL LINOLEUM / ET LINOLEUM / LT LINOLEUMAS / LV LINOLEJS / BG ЛИНОЛЕУМ / RO LINOLEUM / SL LINOLEJ / HR LINOLEUM / BS LINOLEUM / SR LINOLEUM / RU ЛИНОЛЕУМ / UK ЛИНОЛЕУМ / ZH 油毡 / KO 리놀륨 / TH ฟิล์มน้ำมัน / VI VẢI SON / AR الأرضية المشبعة / FA لینولوم / FI KORKKI / NO LINOLEUM / DK LINOLEUM / SE LINOLEUM / MS LINOLEUM

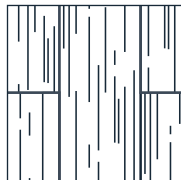

LAMINATE*

FR MÉLAMINÉ / DE LAMINAT / NL LAMINAAT / ES LAMINADO / PT LAMINADO / IT LAMINATO / EL ΛΑΜΙΝΑΤΕ / TR LAMINAT / CS LAMINÁT / SK LAMINÁT / HU LAMINÁLT / PL LAMINAT / ET LAMINAAT / LT LAMINATAS / LV LAMINĀTS / BG ЛАМИНАТ / RO LAMINAT / SL LAMINAT / HR LAMINAT / BS LAMINAT / SR LAMINAT / RU ЛАМИНАТ / UK ЛАМИНАТ / ZH 复合 / KO 라미네이트 / TH ฟิล์มลามิเนต / VI GIẤ GỖ / AR الأرضية الخشبية / FA لامينت / FI LAMINAATTI / NO LAMINATE / DK LAMINAT / SE LAMINAT / MS LAMINAT

* Please refer to Safety Book for floor compatibility

NOT COMPATIBLE : X-FORCE 8.60 (RH96/TY96/E096), X-force 9.60 (RH20/TY20/E020), X-FORCE 12.60 (RH98/TY98/E098), X-FORCE 14.60 (RH99/TY99/E099), X-FORCE 15.60 (RH99/TY99/E099), X-PERT 6.60 (RH64/TY64/E064/RH68/TY68/E068)

COMPATIBILITY : RH9A/RH9L/TY9A/E09A

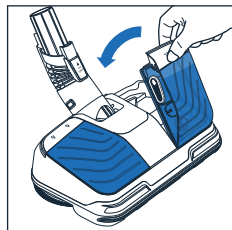
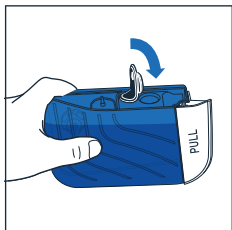
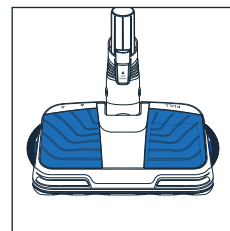
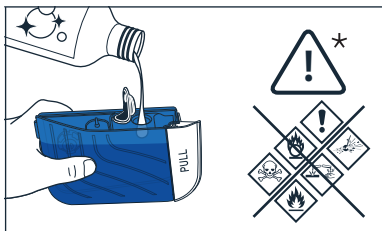
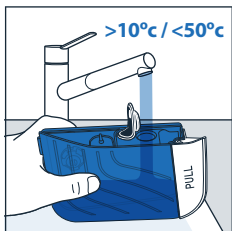
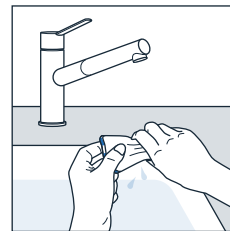
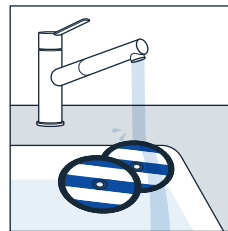
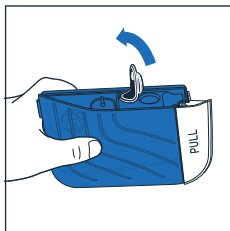
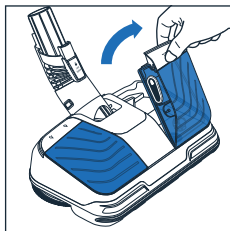
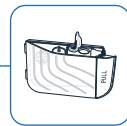

* Please refer to Safety Book for detergents compatibility list

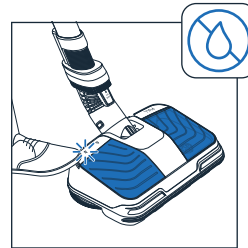
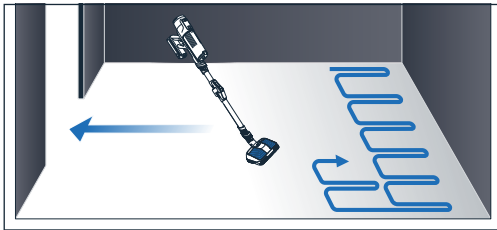
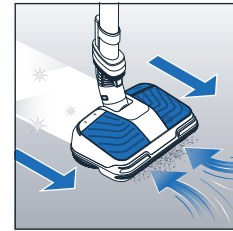
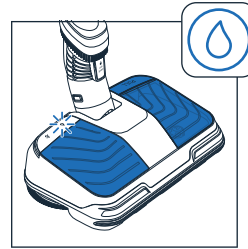
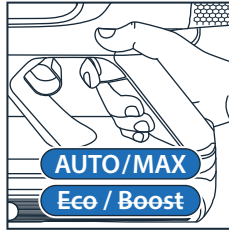
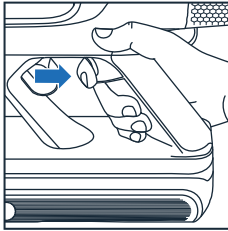

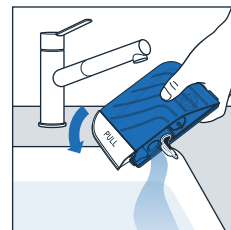
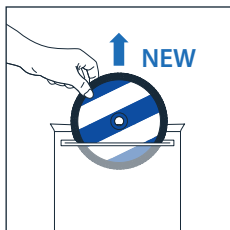
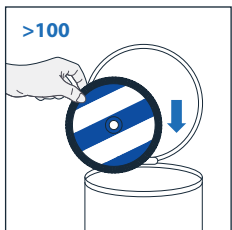
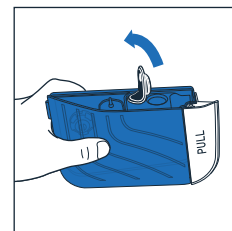
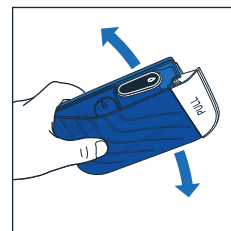
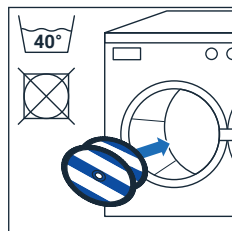
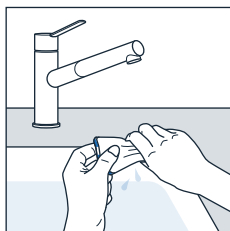
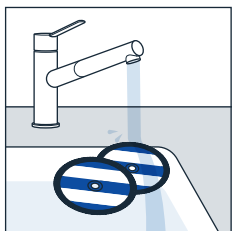
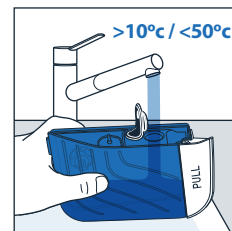
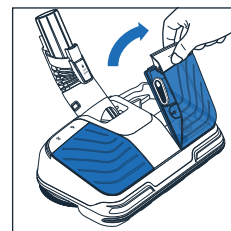
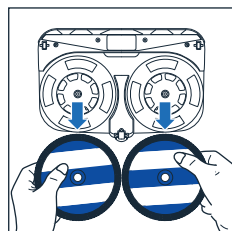
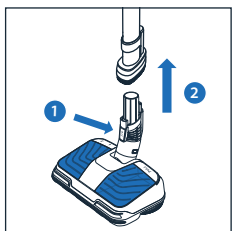
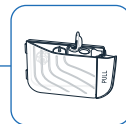



1X MONTH*

*FR Mois / DE Monat / NL Maand /
ES Mes / PT Mês / IT Mese /
EL μήνας / TR Ay / CS Měsíc /
SK Mesiac / HU Hónap /
PL Miesiąc / ET Kuu / LT Mėnuo /
LV Mēnesis / BG Мецед / RO Lună /
SL Mesec / HR Mjesec /
BS Mjesec / SR Mesec /
RU МЕСЯЦ / UK Місяць / ZH 月 /
KO 월 / TH เดือน / VI Tháng /
AR الشهر / FA ماه / FI Kuukausi /
NO Måned / DK Måned / MS Bulan

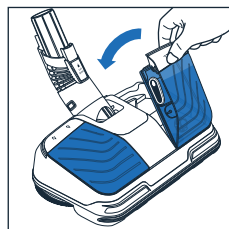
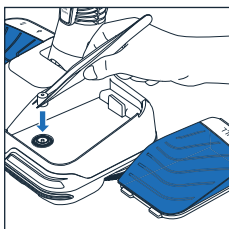
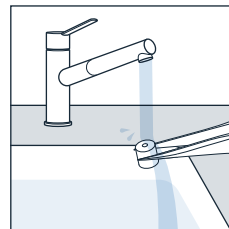
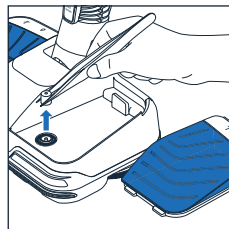
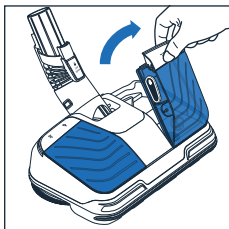

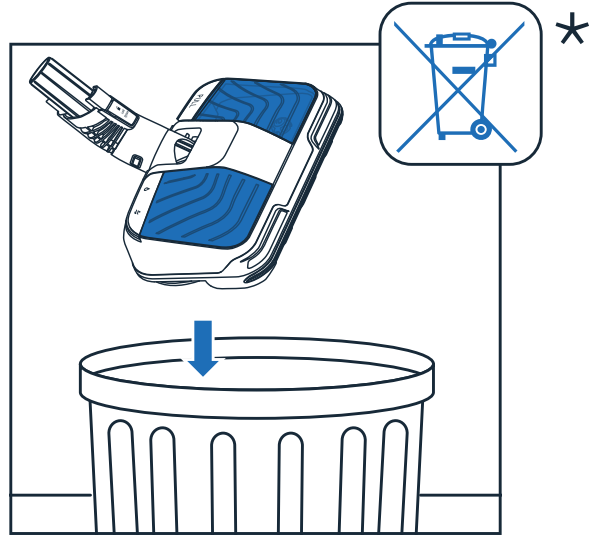
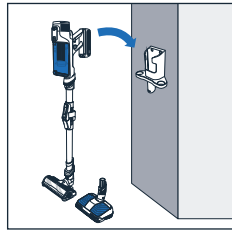
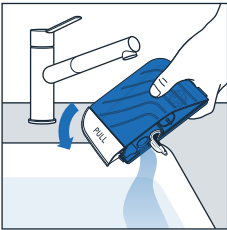
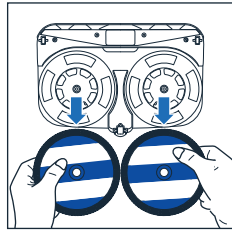
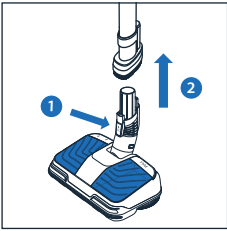

* Please refer to safety book for scrapping

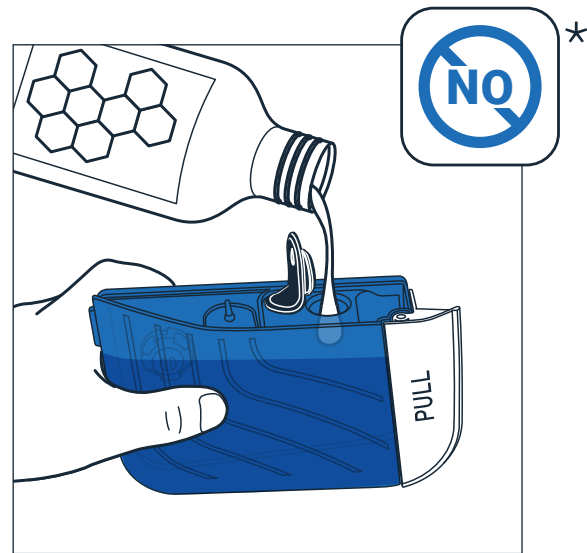
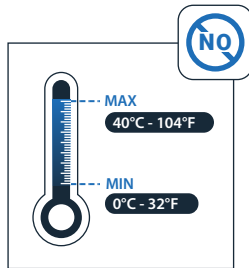
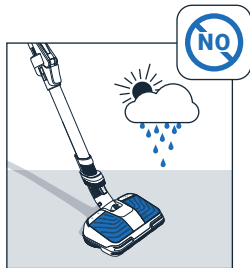
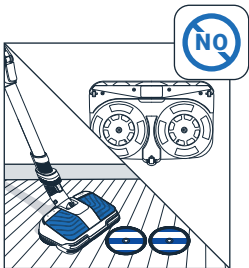
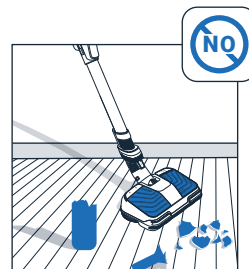
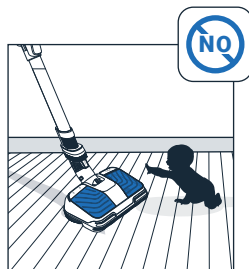

* Please refer to safety book for detergents compatibility

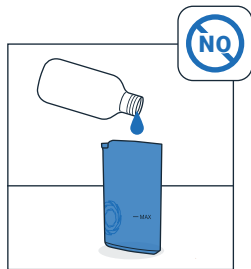
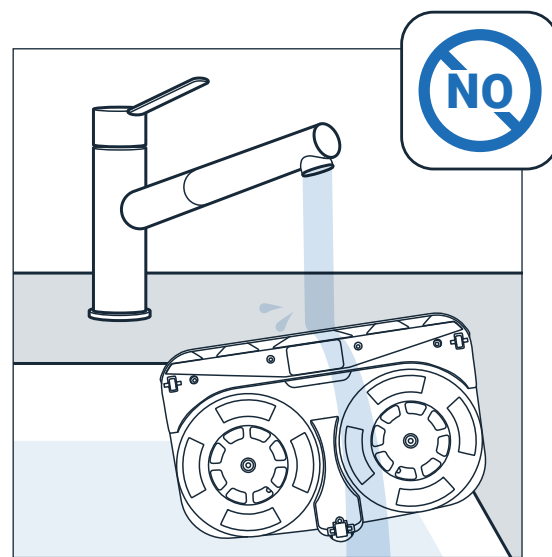
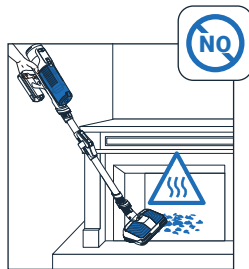
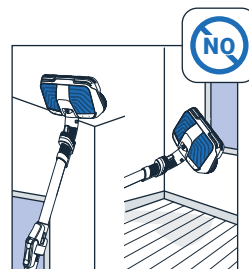
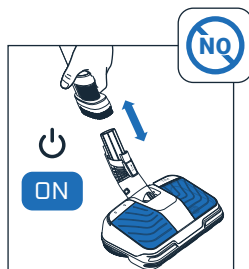

FOR MORE INFORMATION

FR Pour plus d'informations / **DE** Weitere Informationen / **NL** Voor meer informatie / **ES** Para obtener más información / **PT** Para obter mais informações / **IT** Per ulteriori informazioni / **EL** Για περισσότερες πληροφορίες / **TR** Daha fazla bilgi / **CS** Pro více informací / **SK** Ďalšie informácie / **HU** További információk / **PL** Aby uzyskać więcej informacji / **ET** Lisateave / **LT** Daugiau informacijos / **LV** Plašāka informācija / **BG** За повече информация / **RO** Pentru mai multe informații / **SL** Za več informacij / **HR** Dodatne informacije / **BS** Dodatne informacije / **SR** Za više informacija / **RU** Для получения дополнительной информации / **UK** Докладніша інформація / **ZH** 了解更多信息 / **KO** 자세히 알아보기 / **TH** สำหรับข้อมูลเพิ่มเติม / **VI** Để biết thêm thông tin / **AR** للاطلاع على مزيد من المعلومات / **FA** برای اطلاعات بیشتر / **FI** Lisätietoja / **NO** For more information / **DK** For yderligere oplysninger / **SE** För mer information / **MS** Untuk mendapatkan maklumat lanjut

www.rowenta.com
www.tefal.com
www.obhnordica.se

2220006071/03

