

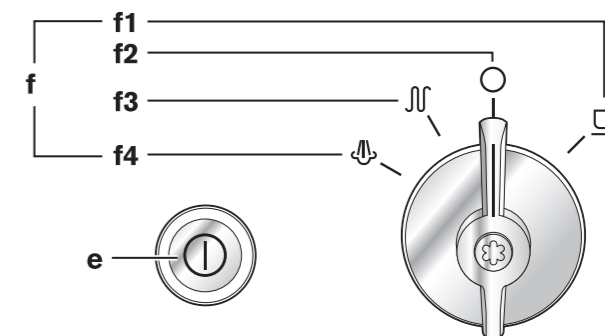

# KRUPS

XP52 SERIE

EN

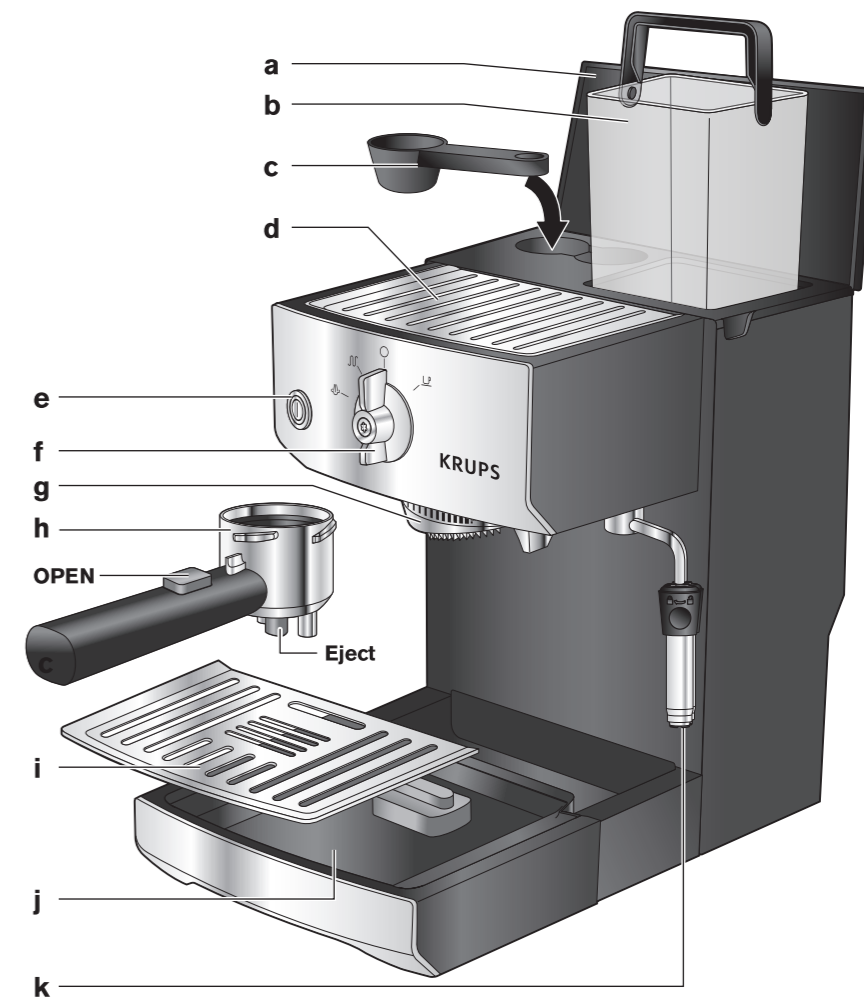

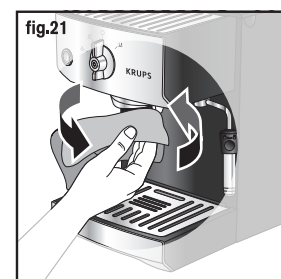
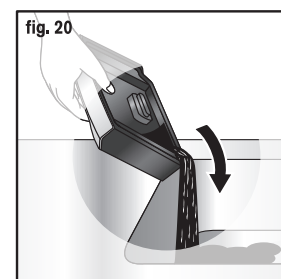
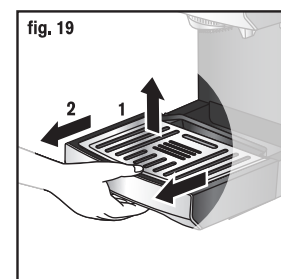
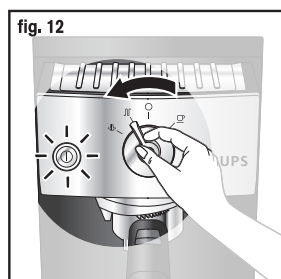
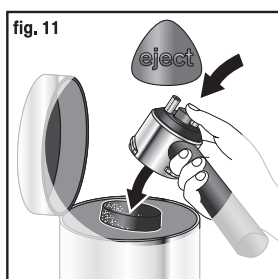
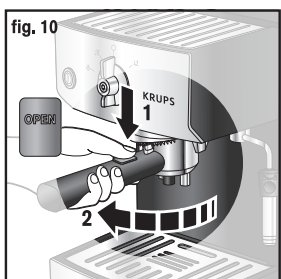
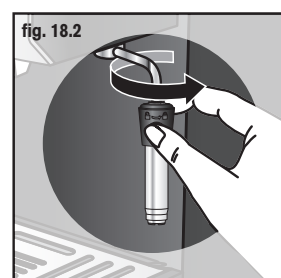
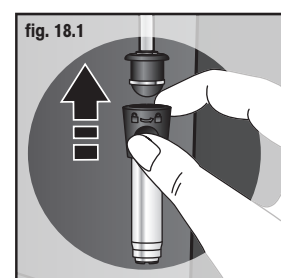
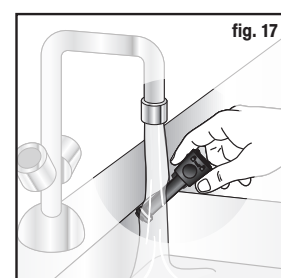
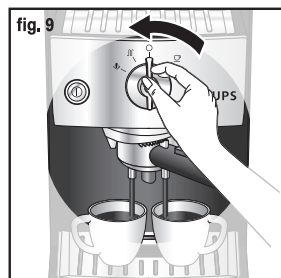
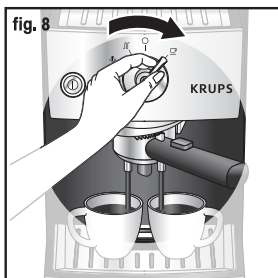
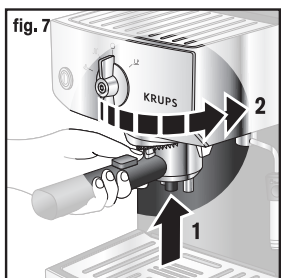
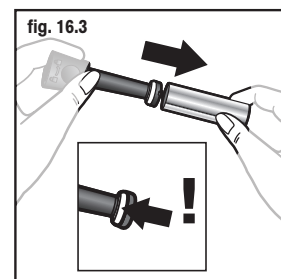
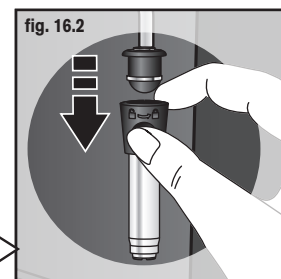
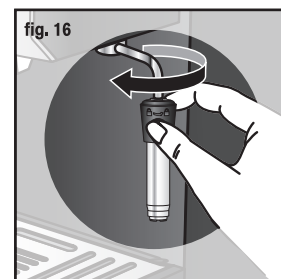
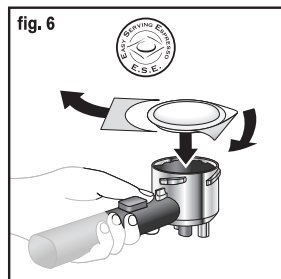
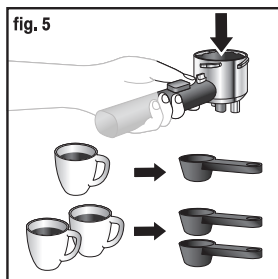
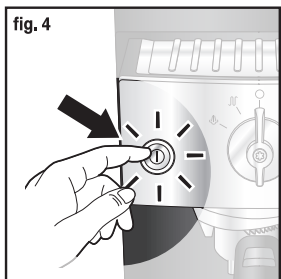
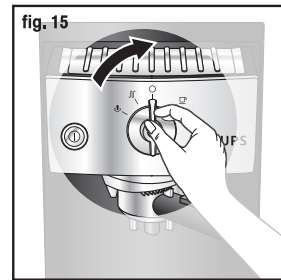
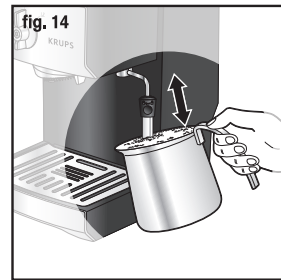
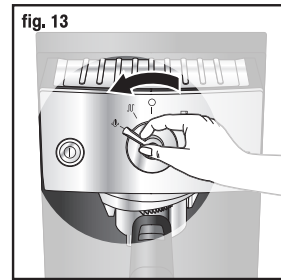
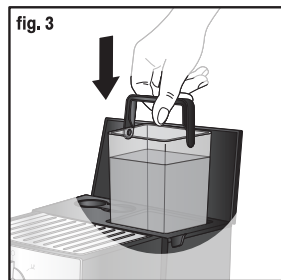
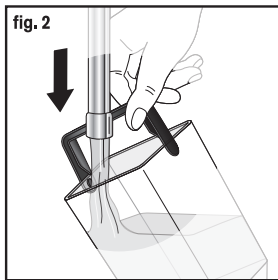
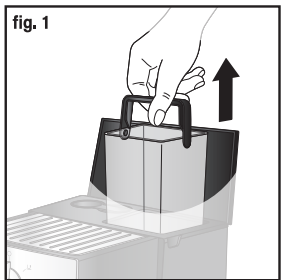

fig. 22

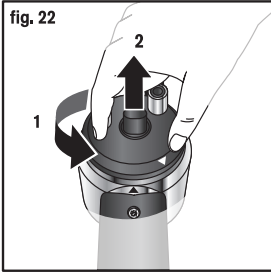

fig. 23



## SAFETY PRECAUTIONS

- **Please read the instructions for use carefully before using your appliance for the first time and retain them for future reference: KRUPS cannot accept any liability for non compliant appliance use.**
- This appliance is not intended for use by persons (including children) with reduced physical, sensory or mental capacities, or lack of experience and knowledge, unless they have been given supervision or instruction concerning use of the appliance by a person responsible for their safety.
- Children should be supervised to ensure that they do not play with the appliance.
- Do not use the appliance if the power cord or plug is damaged. The power cord must be replaced by the manufacturer, its after-sales service or similarly qualified persons in order to avoid danger.
- Your appliance is intended for domestic use inside the home only at an altitude below 2000 m.
- Do not immerse the appliance, power cord or plug in water or any other liquid.
- Your appliance is designed for domestic use only.
- It is not intended to be used in the following applications, and the guarantee will not apply for:
  - Staff kitchen areas in shops, offices and other working environments;
  - Farm houses;
  - By clients in hotels, motels and other residential type environments;
  - Bed and breakfast type environments.
- Always follow the cleaning instruction to clean your appliance:

- Unplug the appliance.
- Do not clean the appliance while hot.
- Clean with a damp cloth or sponge.
- Never immerse the appliance in water or put it under running water.
- **WARNING:** Risks of injuries if you don't use this appliance correctly.
- **WARNING:** After using, do not touch hot surfaces (percolation head, filter holder and steam nozzle), subjected to residual heat.
- Take care when the steam spout is used as steam can cause burns.
- Make sure the filter holder is tightly fitted before running the coffee through.
- This appliance may be used by children of at least 8 years of age, as long as they are supervised and have been given instructions about using the appliance safely and are fully aware of the dangers involved. Cleaning and user maintenance shall not be made by children unless they are older than 8 and they are supervised by an adult.
- Keep the appliance and its cord out of reach of children under 8 years of age.
- This appliance may be used by persons with reduced physical, sensory or mental capabilities, or whose experience or knowledge is not sufficient, provided they are supervised or have received instruction to use the device safely and understand the dangers.
- **Children should not use the device as a toy.**
- Only use an earthed socket to plug the machine in. Check that the power voltage indicated on the nameplate of the appliance corresponds to that of your mains installation.
- Do not use the appliance if it is not working properly or if it has been damaged. If this occurs, contact an authorised service centre.
- For your safety, this appliance conforms with applicable standards and regulations (Directives on low voltage, electromagnetic compatibility, materials in contact with foodstuffs, environment, etc.)

- Any error in the electrical connection will negate your guarantee.
- Do not remove the filter holder containing the ground coffee while the water is going through, because the appliance is under pressure at that time.
- Do not use if the drip tray and the grid are not in place.
- Unplug the appliance when you have finished using it and when you clean it.
- Remove the plug if a problem occurs during operation or before you clean the appliance.
- Do not pull on the cord to unplug the appliance.
- The power cord must never be close to or in contact with the hot parts of your appliance, near a source of heat or over a sharp edge.
- Ensure that the cord and your hands do not touch the hot parts of the appliance (cup warming plate, filter holder, steam nozzle).
- Refer to the instructions for descaling your appliance.
- All interventions other than cleaning and everyday maintenance by the customer must be performed by an authorised service centre.
- The accessories and the removable parts of the appliance are not dishwasher safe.
- For your safety, only use the manufacturer's accessories and spare parts designed for your appliance.
- This appliance is not suitable for making drinks for babies under the age of 2 years.
- All appliances are subject to strict quality control procedures. These include actual usage tests on randomly selected appliances, which would explain any traces of use.
- Take care when the steam spout is used as steam can cause burns.
- To reduce the risk of injury, do not leave the cord hanging over the table or counter, where it can be pulled on by a child or trip someone.
- Never pour cold water in the tank immediately after a brew cycle. Let the appliance cool down between preparations.
- Do not place on or near a hot gas or electric burner, or in a heated oven.
- Do not use appliance for other than intended use.
- Never operate the appliance with wet hands.

Your machine is equipped with a filter holder which boasts three exclusive systems:

- One for the gradual tamping of the espresso ground coffee as the filter holder is being positioned (KTS "Krupps Tamping System").
- Another is for ejecting the used grounds.
- The last is for using E.S.E. (Easy Serving Espresso) or soft pods.

It is also removable, and so can be frequently cleaned to be maintained in perfect working order. For your safety, your filter holder is equipped with a locking system to keep it in place when the pressure rises.

## 1. DESCRIPTION

- |                                       |   |
|---------------------------------------|---|
| <b>A</b> Water compartment lid        | <b>G</b> Percolation head   |
| <b>B</b> Detachable water tank        | <b>H</b> Filter holder with grounds or pod ejection system and gradual coffee tamping system: KTS "Krupps Tamping System": Compatible with ground coffee (1 or 2 cups) and ESE or soft pods |
| <b>C</b> Measuring spoon              |   |
| <b>D</b> Cup warming plate            |   |
| <b>E</b> On / Off button with LED     |   |
| <b>F</b> Function switch              |   |
| <b>F1</b> Coffee position ☐           |   |
| <b>F2</b> Off position ○              |   |
| <b>F3</b> Steam preheating position ∩ |   |
| <b>F4</b> Steam position ☽            |   |
|                                       | <b>I</b> Drip tray grid   |
|                                       | <b>J</b> Drip tray with level indicator   |
|                                       | <b>K</b> Steam nozzle   |

## 2. TECHNICAL CHARACTERISTICS

- Pump: 15 bars
- Filter holder with grounds ejection system. Compatible with espresso ground coffee and all types of pods, ESE or soft.
- Steam function
- Automatic shutoff.
- Removable water compartment (capacity: 1.1 litres).
- Power: 1450 W
- Voltage: 220-240 V – 50/60 Hz
- Anti overheating safety mechanisms
- Dimensions: H. 300 mm, L. 230 mm, P. 280 mm



### IMPORTANT!

**Voltage for use: this appliance is designed only for use with a 220-240 V alternating current.**

**Type of use: Your appliance is EXCLUSIVELY designed FOR USE IN THE HOME.**

## 3. TIPS

- For an espresso with intense flavour, we recommend using freshly ground special espresso coffee which is ideal for the delicacy of this type of coffee, along with cups with a capacity not exceeding 50 ml.
- Keep the espresso ground coffee in the refrigerator, in an air-tight container as it retains its flavour longer.

- Do not fill your filter holder to the brim, but use the measuring spoon (1 tablespoon per cup).
- If you do not use the appliance for more than 5 days, rinse and drain the water tank.
- Before removing the water tank to fill or empty it, always turn the appliance off.
- Always place the unit on a flat, stable, heat-resistant work surface.
- To obtain an espresso at exactly the right temperature, we recommend that you preheat your cups.
- To prolong the life of your appliance, we recommend you use a Claris Aqua Filter System F088 cartridge (accessory not included) and that you descale the appliance at regular intervals.



#### IMPORTANT!

**Before using for the first time, after a prolonged period of inactivity or after descaling, the appliance must be cleaned as described in paragraph 5: “BEFORE FIRST USE”.**

## 4. BEFORE FIRST USE

Before using your espresso machine, clean all the accessories in soapy water and dry them. If you are not using the Claris cartridge, please refer to the paragraph here below “RINSING OF YOUR APPLIANCE”.

### A. INSTALLING THE CLARIS CARTRIDGE (to be done every time the cartridge is replaced)

If you are using a Claris filter cartridge, please follow the procedure to fill it with water:

- Screw the Claris filter into the bottom of the water tank.
- Fill the water tank with water and replace it (fig.2 and 3).
- Turn the appliance on by pressing the “On / Off” button (fig.4).
- Turn the switch to the “steam preheating” position. Once the light stops blinking, turn back the switch to the “off” position.
- Repeat this operation 2 more times.
- To make sure the Claris cartridge is full of water, place a container under the brewing head, turn the switch to the “coffee” position and make sure some water is running through. If not, repeat the above procedure.
- In this manner you can be sure that water is circulating well through the filter cartridge.



#### IMPORTANT!

**This installation procedure must be carried out every time the cartridge is replaced. The Claris cartridge needs to be replaced every 2 to 3 months if it is used daily.**

### B. RINSING YOUR APPLIANCE (to be done on first use and after each cleaning / descaling operation)





- Rinsing out the espresso circuit.

Then rinse the appliance. To do so:

- Open the lid and remove the water tank using the handle (fig.1).
- Fill it with water (fig. 2).
- Replace the water tank by positioning it firmly, to ensure the water inlet is in place, and close the lid (fig.3).
- Turn the appliance on by pressing the “On / Off” button (fig.4).
- Insert the filter holder (without ground coffee) in the appliance (fig.7).
- Place a container of sufficient volume under the filter holder.
- Once the appliance has reached the right temperature, the light stops blinking. Turn the switch to the “coffee” position (fig.8) and let all the water in the tank run through.
- If necessary, stop the operation by turning the switch to the “off” position (fig.9) to empty the container and then resume the operation.
- Empty the container and unlock the filter holder: press the “OPEN” button on the filter holder and turn it to the left (fig.10).

- Rinsing out the steam circuit.

Before using the steam function for the first time, the steam circuit should be cleaned.

- Fill the water tank
- Turn the appliance on by pressing the  button.
- Place a recipient underneath the steam nozzle.
- Turn the switch to the  position, the  button starts to flash.
- When the  button has stopped flashing, turn the switch to the  position and let the water run until steam is formed.
- Keep the steam production going for at least 30 seconds.

## 5. MAKING AN ESPRESSO

In order to release all the aromas of the coffee and ensure your complete satisfaction, this machine pre-infuses each coffee. The pump works for 3 seconds, stops the following 3 seconds and then the cycle continues until the end of the preparation.

### PREHEATING THE ACCESSORIES

For the best results, we recommend that you preheat the accessories (filter holder and cups) without espresso ground coffee. To do so:

- Fill the water tank and turn the machine on. (fig.1, 2, 3 and 4).
- Put the filter holder in place, place the cups below.

As soon as the appliance reaches the required temperature, the light stops flashing.

- Turn the switch to the “coffee” position (fig.8).
- When the cups are filled with hot water, turn the switch to the “off” position. (fig.9).
- Remove the cups.
- Unlock the filter holder: press “OPEN” while turning the filter holder to the left and remove it from the machine. (fig.10).

Note: When the appliance is hot, the espresso cups can be preheated on the cup warming plate.

## WITH GROUND COFFEE

The type of coffee you choose will determine the strength and taste of your espresso. Always use espresso ground coffee. Do not use instant coffee, cafetiere coffee or filter coffee.

- Fill the water tank and turn the machine on (fig. 1, 2, 3 and 4). During the preheating of the appliance, the light flashes.
- Using the measuring spoon, place the espresso ground coffee in the filter holder: one spoon (full to the brim) per cup (fig.5).
- Remove any excess espresso ground coffee from the edge of the filter.



### IMPORTANT!

**Do not tamp the coffee down in the filter holder. The coffee is automatically tamped using the KTS “Krupps Tamping System”.**

- Insert the filter holder in the device by turning it to the right as far as it will go, up to the stop (fig.7).
- Put one or two cups under the filter holder (fig.8).

As soon as the appliance reaches the required temperature, the light stops flashing.

- Turn the switch to the “coffee” position (fig.8).
- When you have the desired amount of coffee, turn the switch to the “off” position (fig.9).
- Unlock the filter holder: press “OPEN” while turning the filter holder to the left and remove it from the machine (fig. 10).
- Remove the used espresso coffee grounds using the ejection system by pressing the “EJECT” button located between the two coffee outlet nozzles (fig.11). Wash the filter holder under running water, pressing “EJECT” to eliminate the remnants of grounds.

The filter holder now can be filled again to prepare other espressos.

## WITH AN “E.S.E.” ESPRESSO POD

“ESE” for “Easy Serving Espresso” is a packaged pod (44 mm diameter) of 7g of selected coffee, ground and compacted between two paper filters, specially designed to make Italian style ristretto (tight) espressos.

This system allows immediate, simple, clean and comfortable use of your machine.

- Fill the water tank and turn the machine on (fig. 1, 2, 3 and 4). During the pre-heating phase, the indicator lamp will flash.
- Tear the excess paper off the pod, put the E.S.E. pod in the filter holder, with the red writing facing down (fig.6).

Be sure to place all the paper inside the filter holder, otherwise there might be leaks.

- If the pod is not positioned correctly, the result in the cup will not be satisfactory.
- Never use two pods together.
- Then, follow steps of pictures 7 to 11.

## WITH A SOFT POD

Your machine is also compatible with soft pods (usually 60 mm in diameter). Given that this kind of pod is not specifically designed for espresso machines, you will get a less full-bodied espresso than with an E.S.E. pod.

- Fill the water tank and turn the machine on (fig. 1, 2, 3 and 4). During the pre-heating phase, the indicator lamp will flash.
- Place a soft pod in the filter holder. Never use two pods together. If the pod is not

positioned correctly, the result in the cup will not be satisfactory.

- Then, follow steps of pictures 7 to 11.

## 6. STEAM FUNCTION

Steam is used to foam up milk (for example to make a cappuccino or a cafe latte) thanks to the cappuccino accessory.

To produce steam, the pump works by emitting an intermittent noise.

After using the steam function, the appliance cools automatically by pumping cold water through the heating system. During the pumping cycles, the excess steam in the heating system is released with the hot water into the drip tray. The steam and noise that accompany this phase are important for cooling the appliance.



### WARNING!

**During and after using the appliance, the metal parts of the steam nozzle can become very hot.**

## USING THE STEAM NOZZLE TO FROTH MILK

- Fill the water tank and turn the machine on (fig. 1, 2, 3 and 4).
- Turn the switch to the “steam preheating” position. The indicator lamp flashes (fig.12).
- Move the steam nozzle towards the outside of the appliance.
- Pour 60 to 100ml of fresh skimmed, semi skimmed or whole milk in a small container of about 1/2 litre and which can pass under the steam nozzle. The milk and its container should be quite cold.
- We recommend that you use pasteurised or UHT milk and that you avoid using unpasteurised milk.
- As soon as the indicator lamp stops blinking, plunge the steam nozzle into the milk.
- Turn the switch to the “steam” position (fig. 13).
- For a good result, hold the nozzle towards the bottom of the container for about 25 seconds while the milk heats (without however touching the bottom of the container). Then, bring the container down gradually so that the nozzle moves up towards the surface (without ever coming out of the milk) (fig.14).
- Once the froth has formed, turn the switch to the “stop” position (fig.15). The appliance will now automatically cool itself by launching 3 intermittent pumping cycles. Once this is automatic operation is complete, you can make a coffee.



### IMPORTANT!

**To prevent the steam nozzle holes from being clogged, the milk foam must not reach the black plastic upper part.**

It is important to clean the steam nozzle after each use to prevent the milk from drying on the inside of the nozzle. To do so:

- Place the steam nozzle in a container with water and repeat the milk frothing operation for 30 seconds.



### ATTENTION!

**The steam nozzle is still hot!**

## USING THE KRUPS XS-6000 AUTO-CAPPUCCINO SET TO FROTH MILK (SOLD SEPARATELY)

The auto-cappuccino accessory makes it easier to make a cappuccino or a caffè latte. It is made up of a special dual-position nozzle, a stainless steel milk container and a pipe.

This accessory may be sold separately.

- Assemble all the different pieces. Choose the caffè latte or cappuccino position on the special nozzle.
- Fill up the milk container and place a cup or a glass underneath the special auto-cappuccino nozzle.
- Turn the switch to the “steam preheating” position.
- Once the light has stopped blinking, turn the switch to the “steam” position.
- Once the froth has been formed, turn the switch to the “stop” position. The appliance will now automatically cool itself by launching 3 intermittent pumping cycles. Once this is automatic operation is complete, you can make a coffee.

To prevent the milk from drying on the auto-cappuccino accessory, we strongly recommend.

- pouring clean water in the container and re-assembling the various components.
- starting a steam cycle.
- clean all of the components with a damp cloth.

## 7. CLEANING AND MAINTENANCE

- Do not wash your espresso machine accessories in the dishwasher.

### CLEANING OF THE APPLIANCE

- Unplug the power supply before cleaning and let the appliance cool down.
- Clean the outside of the appliance from time to time with a damp cloth. After use, the water tank must be emptied.
- Rinse inside the tank regularly.
- When a thin white layer starts to form in the tank, carry out a descaling operation (see paragraph 9 “DESCALING”).

### CLEANING OF THE DRIP TRAY

The drip tray must be emptied after each time the appliance is used. Lift up slightly and remove it from the appliance.

If multiple espressos are prepared one after the other, it should be emptied from time to time (every 7 to 8 espressos approximately) (fig.19 and 20). The presence of water is normal and is not the sign of a leak.

If necessary, clean the drip tray and its grid with water and a little gentle washing-up liquid, rinse and dry. When reassembling the components, make sure everything is in the right place.

### CLEANING OF THE PERCOLATION HEAD AND FILTER HOLDER

- They must be cleaned after each use. Simply wipe a damp cloth over the percolation head (fig. 21) and clean the filter holder under running water and use a small amount gentle washing-up liquid.

- Do not use alcohol or solvent-based cleaning products.
- For best results, you can activate the “EJECT” button several times during rinsing. We recommend that you shake the filter holder thoroughly in order to remove all the water.
- Rinse and dry.
- When not using your espresso coffee maker, do not leave the filter holder on it, in order to prevent wear to the seal.

For more thorough cleaning, the filter holder can be dismantled:

- You can remove the black plastic part where the coffee outlets and the “EJECT” button are to be found: turn it to the left and pull sharply (fig. 22).
- Clean the various components under running water and a little gentle washing-up liquid.
- Rinse and dry.
- Replace the black plastic part in the metal holder, turn it to the right until the two arrows on each component line up.

If the percolation head is heavily clogged up, unscrew the grid using a screw-driver, clean it and refit it, pressing down firmly (fig.23).

### CLEANING OF THE STEAM NOZZLE

- This accessory consists of 2 parts: one part which is the plastic support and the other which is the metal protection cylinder.
- Before cleaning, unlock the nozzle from the articulated arm by turning it to the left (fig.16, 16.2).
- Then slide the metal cylinder along the plastic support (fig.16.3).
- Clean these two parts with tap water and some mild washing-up liquid (fig.17).
- Rinse and dry.
- Once the parts have been properly cleaned, put the metal cylinder back on the support.
- Make sure that you don't damage the silicone seal which makes the nozzle watertight (fig.16.3).
- Insert the nozzle on the articulated arm then lock to the right (fig.18.1, 18.2).

## 8. DESCALING

The guarantee does not cover appliances which become faulty because the descaling operations have not been carried out regularly.

Descale your espresso maker regularly using white vinegar or a packet of citric or sulphamic acid which you can buy in most hardware stores.

We recommend that you use the Krups descaling accessory, reference F054, available in Krups authorized service centres. In addition to two descaling sachets, this accessory includes a water hardness tape tester to assess the required frequency with which your appliance should be descaled, in normal use. The amount of scale depends on the hardness of the water but also the level of use. The frequency of descaling given by the F054 accessory is therefore purely indicative. However, you can refer to the following table:



| DESCALING FREQUENCY          |                     |                       |                          |
|------------------------------|---------------------|-----------------------|--------------------------|
| Ave. number coffees per week | Soft water (<19°th) | Hard water (19-30°th) | Very hard water (>30°th) |
| Less than 7                  | Once a year         | Every 8 months        | Every 6 months           |
| From 7 to 20                 | Every 4 months      | Every 3 months        | Every 2 months           |
| Over 20                      | Every 3 months      | Every 2 months        | Every month              |

**If in doubt, it is recommended to descale every month.**

## DESCALING OF THE STEAM AND COFFEE CIRCUIT

- Empty the tank and put it back in place.
- If your product is equipped with our Claris - Aqua Filter System cartridge F088, please remove this cartridge before the descaling operation.
- Fill the tank with a mixture composed of three parts water for one part white vinegar or a mixture of ½ litre of water and a packet of citric or sulphamic acid available in the shops.
- Insert the filter holder (without espresso ground coffee) into the appliance and lock it by turning it to the right as far as it will go.
- Place a container under the steam nozzle.
- Press the “on-off” button.
- Immediately turn the switch to the “steam” position (without stopping at the “steam preheating” position).
- Let the mixture run through the nozzle until steam appears.
- Turn the switch back to the “stop” position.
- Place a container of sufficient volume under the filter holder.
- Once the light stops blinking, turn the switch to the “coffee” position and half of the mixture run through.
- Turn the machine off using the “on off” button and leave the switch on the coffee position.
- After 15 minutes, turn the machine back on.
- Let the rest of the water run through.
- Turn the switch to the “stop” position.

## RINSING



### IMPORTANT!

**After descaling, perform 2-3 rinsing operations with clear water (without espresso ground coffee), as described in paragraph 5 “using for the first time”.**

**Remember to rinse the steam nozzle by following the instructions below:**

- Place a container under the steam nozzle.
- Press the “on-off” button.
- Immediately turn the switch to the “steam” position (without stopping at the “steam preheating” position).
- Let the water run through the nozzle until steam appears.
- Turn the switch back to the “stop” position.

The appliance is descaled and ready to be used again.

## 9. GUARANTEE

- This product has been designed for domestic use only. Any commercial use, inappropriate use or failure to comply with the instructions, the manufacturer accepts no responsibility and the guarantee will not apply.
- No repairs will be carried out due to a lack of descaling will be covered by the guarantee.
- If you have any problem or query please contact our Customer Relations Team for expert help and advice.

Helpline: 0845 330 6460 - UK

(01) 677 4003 - Ireland

or consult our web site: [www.krups.co.uk](http://www.krups.co.uk)

## 10. PROBLEMS, PROBABLE CAUSES AND CORRECTIVE ACTIONS

| PROBLEMS  | POSSIBLE CAUSES  | SOLUTIONS  |
|---|--|--|
| The espresso is not hot enough.                                     | The cups and the filter holder are cold.   | Preheat the accessories: cups and filter holder (see paragraph 6).                         |
| The filter holder is blocked  | You forgot to unlock the filter.   | Press "OPEN" while turning the filter holder to the left.                                  |
| The grounds are not dry after water has run through.                | You have not tightened the filter holder properly.   | Tighten the filter holder by turning it to the right as far as it will go, up to the stop. |
| The coffee flows too slowly.  | The flow rate depends on the fineness of the coffee used and can vary when preparing the espresso. |  |
|   | The ground coffee is too fine, too oily or floury.   | Choose a slightly larger grained ground coffee.  |
|   | The filter holder is dirty.  | Clean your filter holder (see paragraph 8).  |
|   | The water drip-through grid is clogged.  | When the appliance has cooled, clean the percolation head with a damp cloth. (fig.21).     |
| The water does not run through.                                     | No water in the tank. Tank poorly fitted.  | Fill the tank. Press firmly on the tank.   |
|   | The filter is clogged. The ground coffee is too fine.  | Clean the filter holder (see paragraph 8) and try a less fine grind.                       |
|   | Your device is scaled up.  | See paragraph 9.   |
|   | The Claris cartridge has been replaced but not primed.   | See paragraph 5.   |
| Water leaks from the filter holder after an espresso has been made. | The switch has not been positioned on the «stop» position.   | Turn off your appliance by positioning the switch on the «stop» position. (fig.9).         |
|   | Formation of scale because of especially hard water.   | Descale the appliance according to the manual (see paragraph 9).                           |

| PROBLEMS   | POSSIBLE CAUSES   | SOLUTIONS   |
|--|---|---|
| Coffee grounds in the cup.                           | The filter holder is clogged.   | Clean the filter holder with hot water. Press "EJECT" to eliminate the remnants of the grounds. Shake to drain the water. |
|  | The grind is too fine.  | Choose a slightly larger grind.   |
| The water tank leaks when it is carried.             | The valve at the bottom of the tank is dirty or defective.                                    | Wash the water tank and operate the valve at the bottom of the tank with your finger.                                     |
|  | The valve is blocked by scale.  | Descale the appliance (paragraph 9).  |
| Water leaks under the appliance.                     | Internal leak.  | Check the position of the tank. If the fault persists, do not use the appliance, contact an approved service centre.      |
| Water leaks under the drip tray.                     | Water can be present and/or flow when you remove the drip tray. This is not a sign of a leak. |   |
| Crackles are heard in the filter holder.             | Normal phenomenon: the filter holder security lock.   |   |
| The pump is unusually noisy.                         | No water in the tank.   | Stop the appliance, fill the water tank and turn the machine back on.   |
|  | Tank poorly fitted.   | Press down firmly on the tank.  |
| The cups are not filled equally.                     | The filter holder is clogged.   | See paragraph 8.  |
| The machine leaks on the sides of the filter holder. | The filter holder has not been properly positioned.   | Put the filter holder in place and lock it (by turning it to the right as far as it will go, up to the stop).             |
|  | The edge of the filter holder is clogged by ground coffee.                                    | Remove excess coffee.   |
|  | Pod poorly positioned in the filter.  | Place all the paper inside the filter holder.   |

| PROBLEMS                                  | POSSIBLE CAUSES   | SOLUTIONS   |
|---|---|---|
| Your espresso tastes bad.                 | After descaling, the rinsing was not performed properly.    | Rinse the device according to the manual (see paragraph 9).                                     |
| The appliance does not work.              | The pump was unprimed due to lack of water.                 | Fill the water tank and reprime the pump (see paragraph 5). Avoid completely emptying the tank. |
|   | The detachable water tank is not properly clicked in place. | Click the tank into place by pressing firmly.   |
|   | The Claris cartridge has been replaced but not primed.      | See paragraph 5.  |
| The steam nozzle does not froth the milk. | The steam nozzle is blocked or scaled up.                   | Descalcify the steam nozzle (see paragraph 9) or unblock it with a needle.                      |
|   | The milk is not cold or not fresh enough.                   | Use fresh, cold milk. Try using a different brand of milk.                                      |
|   | The shape of the container is not appropriate.              | Use a small pitcher.  |

## 11. END-OF-LIFE ELECTRONIC PRODUCT



### Environmental protection first!



Your appliance contains a lot of recoverable or recyclable material.

When disposing of it, take it to a local civic waste collection point.