

- Fill the iron with tap water to the max mark on the water tank.
- Be sure that variable steam lever is set to minimum.
- Stand iron on heel and plug in.
- Set thermostat to ●●● setting.
- Once heated, unplug iron.
- Hold iron horizontally over the sink with the soleplate pointing away from body.
- Move the variable steam lever completely to the right and hold in the self clean position for one minute.



**Warning: Doing this will cause steam and hot water to be ejected from the soleplate. Take all proper precautions and hold iron away from body.**

- Move the iron gently back and forth and side to side until all water has run through plate.
- Carefully wipe all water and material from the soleplate with an old towel, as the water and minerals can stain the soleplate (although this has no effect on glide or performance.)



**Warning: Iron and soleplate may still be very hot. Exercise care while wiping.**

- Place iron on heel and leave to cool.

Before using iron after self cleaning, test steam and burst of steam on an old towel or cloth than can be discarded.

## Vapodur Valve

To ensure the iron continues to steam efficiently, open and close the valve a few times after each use. This is done by moving the variable steam control lever left to right a few times.

## After ironing

1. Turn the temperature dial to the min setting. Slide the steam lever to the dry position ☼ .
2. Unplug the appliance.
3. Place the iron on its heel and allow to cool completely.
4. Empty water from the appliance before storing. We recommend emptying the iron when not in use.
5. To protect the soleplate, we recommend storing iron on its heel.

## Cleaning and Maintenance

When cold and unplugged, the iron can be cleaned with a damp cloth and wiped dry.

**Never use household cleaners or solvents.**

Cleaning the soleplate  
Rowenta soleplates have excellent non-stick properties and can be wiped clean when cold.

- In normal use a draggy coating may build up on the soleplate (starch, detergent build-up, burnt synthetic fibers). This can be easily removed by using the Rowenta Soleplate Kit or a quality hot iron soleplate cleaner available at most stores. The Rowenta kit is also available through our website: [www.rowentausa.com](http://www.rowentausa.com)
- To prevent scratching of the soleplate, do not iron over sharp objects (zippers, etc.). Do not place the iron on rough surfaces, e.g. metal iron support, which may scratch the soleplate.

## Troubleshooting

Issues	Possible causes	Solutions
Iron does not heat.	Not properly plugged in.	Check that iron is plugged in correctly.
	The temperature control is set too low.	Set the temperature control to a higher temperature.
	Auto-off has engaged (depending on model).	Move iron or shake it gently to reactivate.
Not enough steam.	There is insufficient water in the tank.	Fill the water tank.
	Iron is not set to a steam setting.	See section called "steam ironing".
	The Anti-drip function is active.	Wait for the soleplate to reach the correct temperature.
Iron is emitting a brown or white substance.	Water may need to be changed due to hardness or organic matter.	See section "Water recommendations". Switch to spring water or mix tap water with distilled water.
	Garment has not been rinsed sufficiently.	Ensure garments are rinsed thoroughly to remove any detergent deposits or chemicals on new garments.
Iron is leaking	Over use of burst button.	Allow more time between each burst.
	Distilled or softened water being used.	See section "Water recommendations". Switch to spring water or mix tap water with distilled water.
	Overfilled.	Do not fill past max line on tank. Be sure to close the cover at filling inlet.
The Auto off light is flashing.	Auto-off has engaged. (depending on model)	Move iron or shake gently to reactivate.
Build up on the soleplate.	Starch use.	Spray reverse side of fabric and allow starch to penetrate.
	Burnt material. Ironing at too high temperature.	Be sure to set temperature according to fabric being ironed.
Spray function does not work.	Priming may be necessary on first use.	Fill with water. Hold cold iron horizontally. Place finger over the spray nozzle to create a vacuum. Press the spray button 4 to 5 times. Remove finger from nozzle, press spray button a few more times.

**If troubleshooting does not assist, before consulting the retailer regarding their return/exchange policy, please telephone consumer service at 781-396-0600.**

**In the interest of improving products, Rowenta reserves the right to change specifications without prior notice.**

## LIMITED WARRANTY

This Rowenta product is warranted for 1 year from date of purchase against defects in material and workmanship. During this period, any Rowenta product that, upon inspection by Rowenta, is proved defective, will be repaired or replaced, at Rowenta's option, without charge to the customer. If a replacement product is sent, it will carry the remaining warranty of the original product. This warranty does not apply to any defect arising from a buyer's or user's misuse of the product, negligence, failure to follow Rowenta's instructions, use on current or voltage other than that stamped on the product, or alteration or repair not authorized by Rowenta. Repair or disassembly by anyone other than a Rowenta authorized service center will void the warranty. THE WARRANTIES SET FORTH HEREIN ARE EXCLUSIVE AND NO OTHER WARRANTIES, EXPRESS OR IMPLIED, INCLUDING BUT NOT LIMITED TO ANY WARRANTY OF MERCHANTABILITY OR FITNESS FOR A PARTICULAR PURPOSE OR USE, ARE MADE BY ROWENTA OR ARE AUTHORIZED TO BE MADE WITH RESPECT TO THE PRODUCT.

Some states do not allow limitations on how long an implied warranty lasts or do not allow the exclusion of incidental or consequential damages, so the above limitations may not apply to you. This warranty gives you specific legal rights, and you may also have other rights, which vary from state to state.

If you believe your product is defective, bring the product (or send it, postage prepaid) along with proof of purchase to the nearest authorized Rowenta Service Center (see below). If you send the product, please include a letter explaining the nature of the claimed defect.

## CORRESPONDENCE CAN BE SENT TO:

**ROWENTA**  
196 Boston Avenue  
Medford, MA 02155, U.S.A.  
Tel: (781) 396-0600  
[www.rowentausa.com](http://www.rowentausa.com)

**OFFICE LOCATION ONLY. Letters will be accepted at this address and packages without a return authorization number will be refused or forwarded to a service center. To service product see service center information below.**

## SERVICE CENTER INFORMATION:

If your appliance needs service, ship the product to your nearest regional service center. Be sure to put your name on the outside of the shipping box (no P.O. boxes please), include a brief note describing the issue, and include a copy of the sales receipt if the product is in warranty. If in warranty, Rowenta will repair or replace the product at their discretion. If the product is out of warranty, you will be advised of the cost of repair before any work begins.

Turnpike Appliance  
3495A Lawson Blvd.  
Oceanside, NY 11572  
516-483-5596

Authorized Appliance  
1644 West Ogden Ave  
Downers Grove, IL 60515  
630-852-1550

California Electric  
1170G Burnett Ave  
Concord, CA 94520  
925-827-1011

**SERVICE CENTER INFORMATION IS SUBJECT TO CHANGE.**  
Please visit our website at [www.rowentausa.com](http://www.rowentausa.com)  
or call 781-396-0600 for automated service center information.

# ROWENTA

## PROFESSIONAL

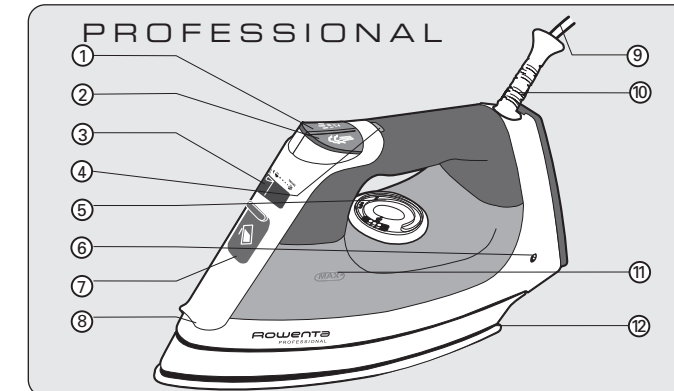

## Appliance description

- |  |  |
|--|--|
| 1 Spray button   | 7 Water filling inlet with cover                 |
| 2 Extra long burst button  | 8 Spray nozzle                                   |
| 3 Variable steam control with self clean function and dry position | 9 Cord   |
| 4 Auto off light   | 10 Cord support                                  |
| 5 Temperature control dial   | 11 Water tank with maximum water level indicator |
| 6 Thermostat light   | 12 Soleplate                                     |

## IMPORTANT SAFETY INSTRUCTIONS

When using this appliance, basic safety precautions should always be followed including the following:

Read all instructions before using this product.

- Use appliance only for its intended use.
- To protect against a risk of electric shock, do not immerse the appliance in water or other liquids.
- The appliance should always be turned off before plugging or unplugging from outlet. Never yank the cord to disconnect from outlet, instead grasp plug and pull to disconnect.
- Always disconnect appliance from electrical outlet when filling with water or emptying when not in use.
- Do not allow cord to touch hot surfaces. Let iron cool completely before putting away. Loop cord loosely around iron when storing.
- Do not operate appliance with a damaged cord or if appliance has been dropped or damaged.
- To avoid the risk of electric shock, do not disassemble the appliance. Ship it to the nearest authorized Rowenta approved service center for examination and repair. Incorrect reassembly can cause a risk of electric shock when the appliance is used.
- Not intended for use by children. Close supervision is necessary for any appliance being used near children. Unsupervised use can result in fire or personal injury. Do not leave appliance unattended while plugged in, on an ironing board, or while it is still hot.
- Burns can occur from touching hot metal parts, hot water or steam. Use caution when you turn a steam iron upside down. There may be hot water in the reservoir.
- Do not direct steam at people, animals or iron clothes while they are being worn.
- The use of accessory attachments is not recommended by Rowenta and may result in fire, electric shock or personal injury.

## SPECIAL INSTRUCTIONS

- This is a 1500, 1600, 1700 or 1750 watt appliance. To avoid a circuit overload, do not operate a high wattage appliance on the same circuit.
- If an extension cord is absolutely necessary, the marked electrical rating should be at least as great as the electrical rating of the appliance. Cords rated for less amperage may overheat. Care should be taken to arrange the cord so that it cannot be pulled or tripped over unintentionally.
- Your Rowenta appliance is intended for household use only.

## SAVE THESE INSTRUCTIONS

### Before use

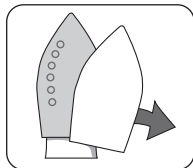

- **Remove soleplate cover before using iron.**
- Remove all packaging from the iron.
- Please read all of the Instructions for Use and the Important Safety Guards carefully.
- It is normal for a small amount of smoke and a light odor to be produced the first time it is used. This will quickly disappear.
- Particles may emit from iron during first use. They are not harmful and should disappear after the iron has been allowed to steam.

### Helpful Hints

- When ironing, start with fabrics that require a low temperature setting (•) and finish with those which need the highest temperature (•••).
- Mixed fiber fabrics should be ironed on the temperature for the most delicate fabric. For example a shirt that is 60% cotton and 40% polyester should be ironed at the (•) setting for synthetics.
- If spray starch is used, spray it onto the reverse side of the garment. Allow starch to penetrate before ironing by setting garment aside for 30 seconds.
- For best results, use a mesh type ironing board to allow excess steam to escape.
- For delicate fabrics, we recommend carrying out a test on an unobtrusive area of the garment such as an inner seam.
- Adhere to manufacturer recommendations on garment label.

### 3 Way Auto-Off (depending on model)

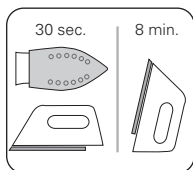

If your iron is equipped with auto-off and the iron is not moved while it is plugged in, an internal safety switch will turn it off. It will turn off in 8 minutes if left vertically or in 30 seconds if left on its soleplate or tipped over. The auto-off light will remain on and lit during ironing.

The light will flash when the auto-off feature has engaged. To deactivate feature, move the iron or shake it gently. Wait until iron is fully reheated before use.

**Auto off is not an on/off switch. Always unplug the iron when not in use.**

### Filling with water

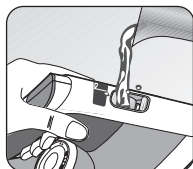
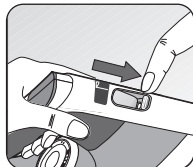

- Ensure the iron is unplugged.
- Slide the variable steam level completely to the left (☞).
- Rest the iron on heel and tilt it forward approximately 1 inch. If the iron is equipped with a covered filling inlet, open the filling inlet by sliding the cover down.
- Fill with water (containing no additives) to the max mark on the water tank. We recommend using a water pitcher rather than filling under the tap.
- If equipped with filling inlet cover, slide cover to close.

If you need to add water during ironing, UNPLUG the iron and follow the steps above. Ensure iron is fully reheated (thermostat light goes out).

### Water Recommendations

#### Tap water

Rowenta irons are designed to be used with REGULAR TAP WATER (up to 12 grains of hardness). If your water is harder than this, Rowenta recommends mixing half tap water with half distilled water which reduces the hardness; or just use bottled spring water. Never use 100 % distilled water as this can cause the iron to spit and leak.

#### Softened water

There are many types of household water softeners and the water from many of them is perfectly acceptable for use in an iron. However, some types of softeners, particularly those that use chemicals such as salt, can cause the appliance to leak or spit during use. If you experience this type of problem, we recommend that you try using bottled spring water or untreated tap water. Never use 100 % distilled water.

Once you have changed water it will take several uses to correct the problem. Rowenta recommends trying the steam function for the first time on an old towel or cloth that can be discarded to avoid damaging your clothes.

#### Iron and other impurities

If your water supply contains large amounts of iron or organic matter, these minerals can collect inside the appliance and eventually appear as brown stains. If you experience these problems Rowenta recommends using bottled spring water. Never use 100 % pure distilled water.

#### Always remember:

Battery water and water containing additives (such as starch, perfume or fabric conditioner condensed water from driers) may not be used. Such additives can affect the properties of the steam and, at high temperatures, can form deposits in the steam chamber, which will mark the laundry when they are emitted through the steam vents. **Descaling liquids /agents should not be used.**

### Selecting the Temperature

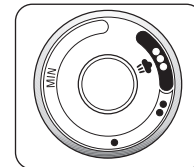

Set the temperature control dial according to the fabric you are ironing. Check the garment label for appropriate setting. We recommend using the chart below as a guide.

Ironing label	Fabric	Temperature control
	Synthetics e.g. polyester, silk, viscose	•
	Wool	••
	Cotton, linen	•••

Thermostat light will be on as iron is heating. When light goes out iron is ready to use. When heating a cold iron, please allow thermostat to cycle twice before use (thermostat light will go on and off twice).

### Steam ironing

**Warning!** Never iron or steam clothes while they are being worn.

**Before ironing for the first time, fill iron and allow to heat. The iron should be allowed to emit steam for 1 to 2 minutes while pressing the extra long steam button a few times to remove any impurities. This should also be done if iron is not used regularly.**

Steam is only produced when the temperature dial is set to the shaded area (after •• setting).

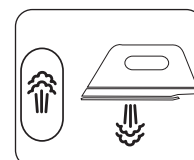
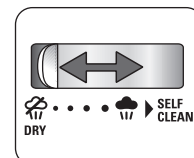

#### Variable Steam

Maximum steam setting should only be used when the iron is set to the highest temperature setting (•••). Steam will be produced when iron is used horizontally.

#### Extra Long Burst Button (Depending on model)

(temperature setting at maximum) Your iron is equipped with a Extra Long Burst, which allows you to remove wrinkles, specifically on dry and thick fabrics. By pressing the Extra Long Burst Button (🔴) steam is pushed deeper into the fabric for excellent results. The pressure generated may cause a slight noise.

**This is not a technical defect!**

Leave an interval of 2 seconds between bursts.

#### Burst of steam (Depending on model)

This feature is ideal for removing stubborn wrinkles or pressing in sharp creases in horizontal use. When the temperature control is set to the steam zone (after ••) the burst of steam can be used by pressing the burst of steam button. Leave an interval of 4 seconds between bursts.

### Vertical burst of steam (temperature setting at maximum – steam control setting at Dry Position)

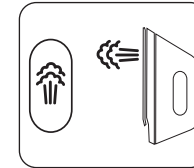

This feature is ideal for hanging clothes, drapes, curtains, etc. When the temperature control is set to the steam zone setting vertical steam can be used. Press the burst of steam button repeatedly while moving iron from bottom of garment to top.

Leave an interval of 2 seconds between bursts. **Warning! Never direct steam at persons or animals.**

### Dry ironing and Dry Position for professional finish results

To iron without continuous steam turn the steam control to the Dry position (☞). It will engage with a "click". Set the temperature to suit the type of fabric (care points •, •• or •••). Dry Position allows you to remove the residual dampness of your fabrics for a professional result.

### Spray setting

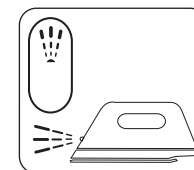

This feature is ideal for removal of stubborn wrinkles and set in creases. Ensure there is water in the tank then press the spray button. Do not spray silk.

### Anti-Drip System (depending on model)

In order to produce steam, all irons require a high temperature. If the soleplate is not hot enough some of the water will not turn to steam and can spit or leak from the soleplate. The Anti-Drip system automatically switches off the steam when ironing at low temperatures to prevent spitting.

### Anti-Calc System (depending on model)

Minerals in water can build up in the steam chamber. The Anti-Calc system contains a special material that neutralizes the harmful minerals. This system is designed to extend and maintain the high steam performance of the iron. The cartridge is not replaceable. Note: Do not use descaling agents in your iron.

### Self Clean

**Warning! Do not use descaling agents. They can damage the lining of the steam chamber.**

This feature allows loose mineral deposits and other impurities to be flushed from the soleplate.

Self Clean should be carried out occasionally and at least once a month.