

Moulinex

mega 2kg

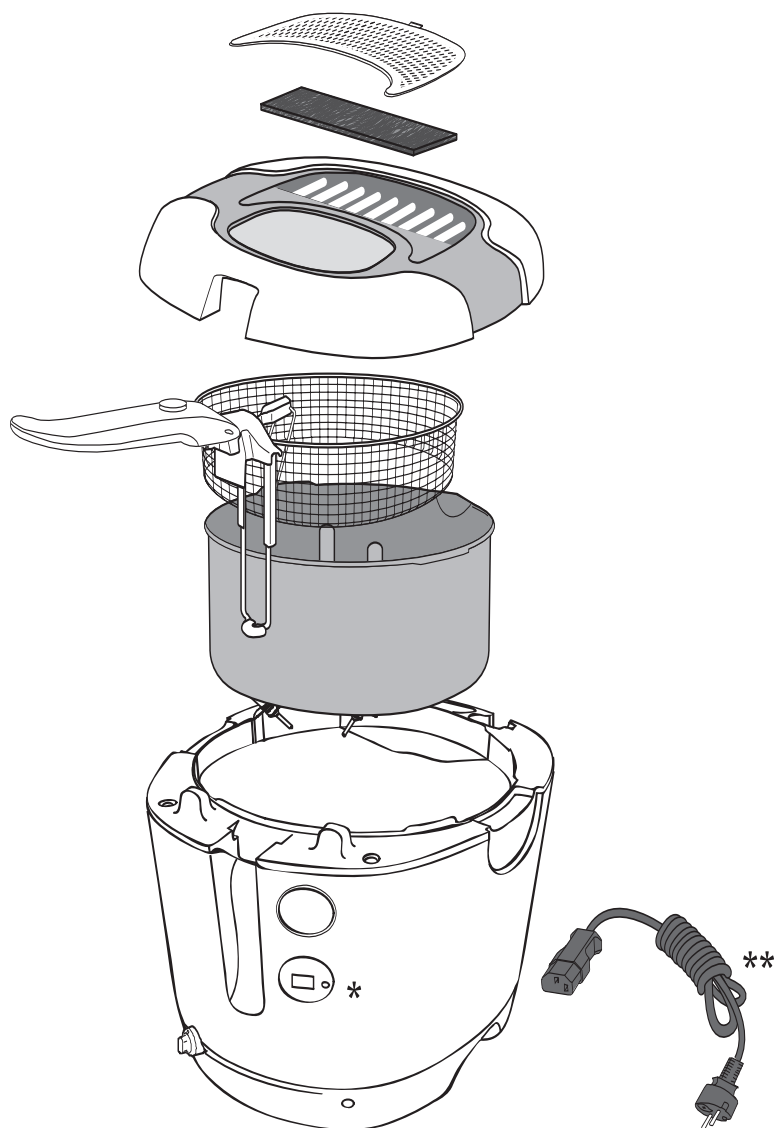



*selon modèle • depending on model • je nach Modell • a seconda del modello • según modelo • consoante os modelos • Ανάλογα με το μοντέλο • В зависимости от модели • Залежно від моделі • zależnie od modelu • az egyes modellek szerint • podle modelů • podľa modelov • В зависимости от модели • În funcție de model • modellere göre • Зависно од модела • zavisno od modela • Ölede na model • حسب الموديل • بر حسب مدل

** Cordon amovible • Removable cord • abnehmbare Zuleitung • Afneembaar snoer • Cavo amovível • Cordón amovible • Cabo de alimentação • Αποσπώμενο καλώδιο • Aftagelig ledning • Löstagbar sladd • Avtakbar ledning • Irrotettava johto • Съемный кабель питания • З'ємний шнур • Odłączany przewód • Odnímatelná přívodní šňůra • Hálózati csatlakozó kábel • Подвижен кабел • Odoberateľný prívodný kábel • Cablu de alimentare detașabil • Demontažni kabl za napajanje • Odvojivi kabl • Odvojivi priključni vod • Odstranjivi kabl • Çıkarılabilir güç kablosu • سلك كهريائي قابل الفك - سيم برق مجزا

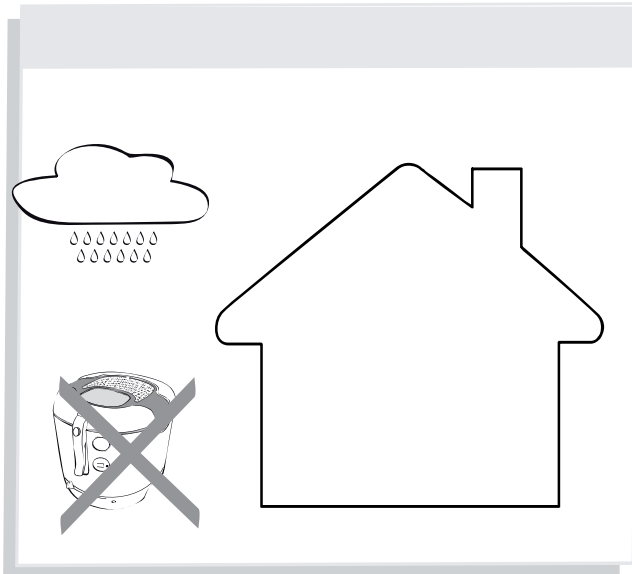
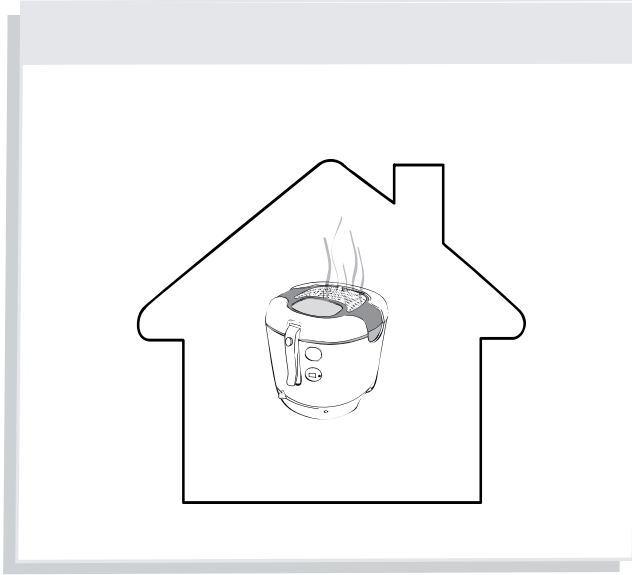

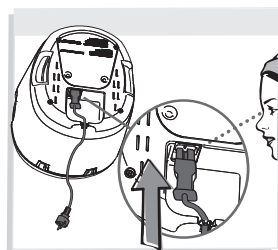
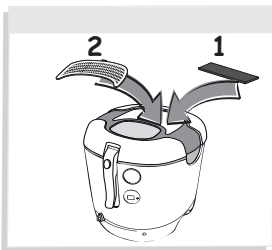
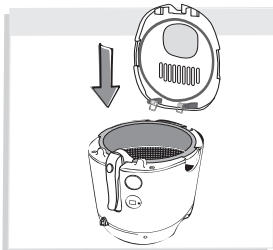
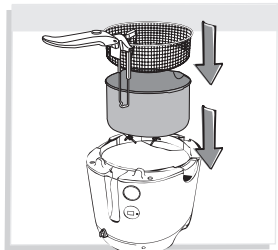
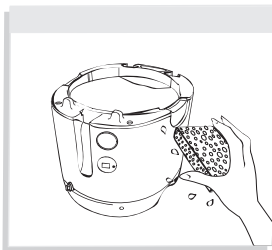
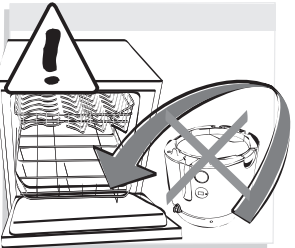
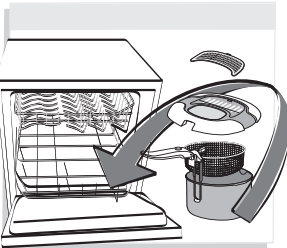
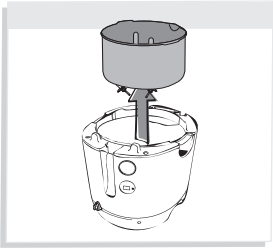
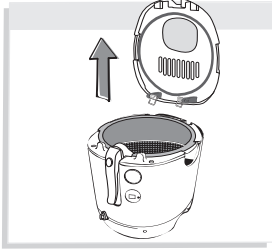
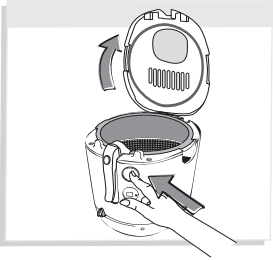
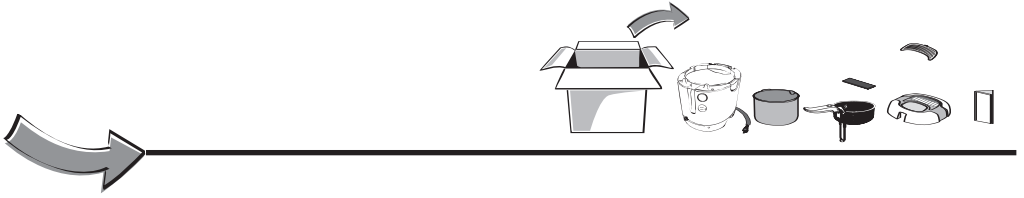



Min 3 L
↓
Max 3,3 L

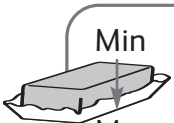
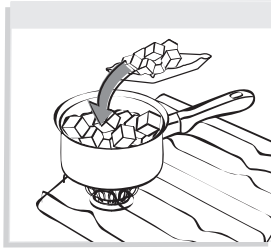
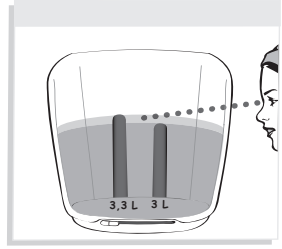

Min 2,6 Kg
↓
Max 2,8 Kg

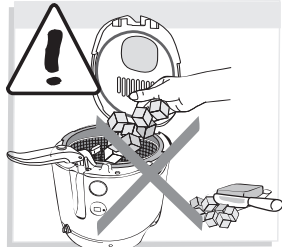
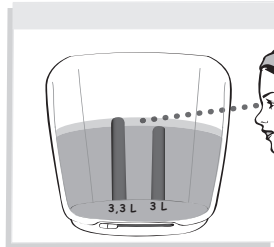

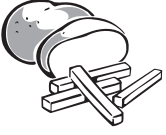

Max 2 Kg



1 Kg

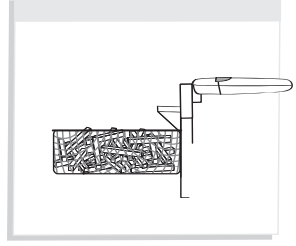
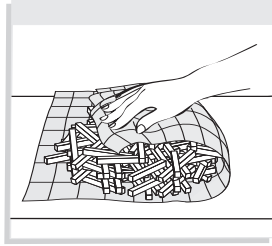

Max 1,5 Kg



750 g

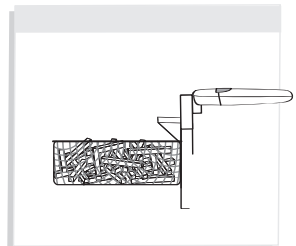
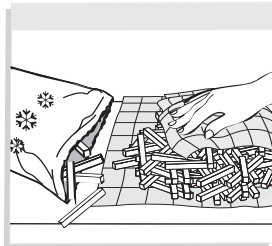
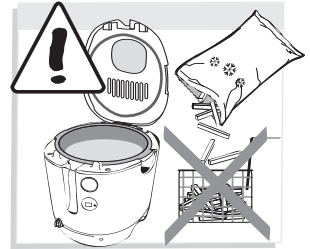
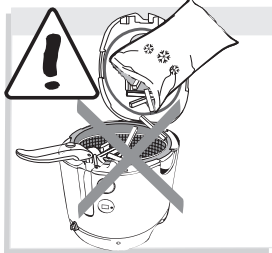

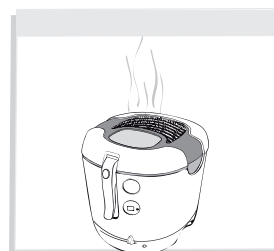
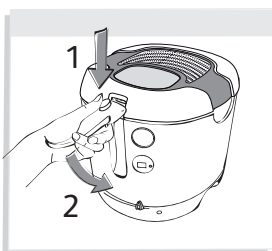
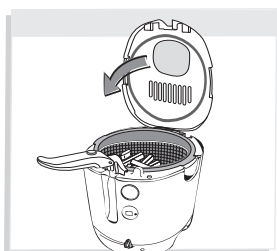
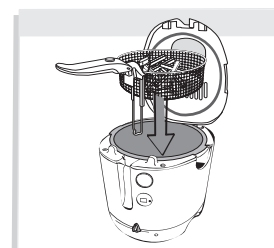
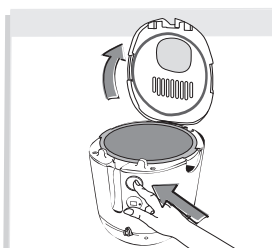
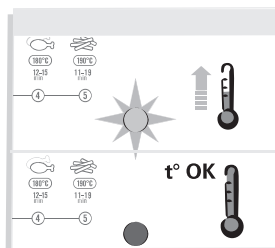
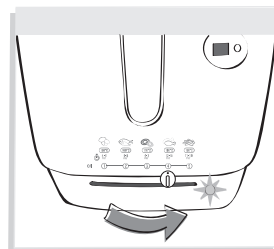
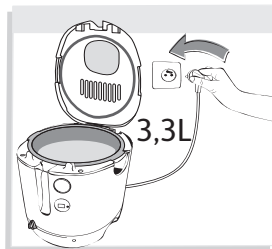



| | Nb | | | |
|--------------|-------|--------|--------------------|-------------------------------|
| | | 2 Kg | 190°C | +/- 19-25 min |
| | | 2 Kg | ① 160°C ② 190°C | +/- 14-17 min +/- 9-11 min |
| | | 1 Kg | 190°C | +/- 11-15 min |
| | | 1 Kg | 170°C | +/-12-16 min |
| | 8-10 | | 190°C | +/- 9-10 min |
| | 3/4 | | 180°C | +/-12-19 min |
| | 1-2 | | 160°C | +/- 4-7 min |
| | | 300 g | 150°C | +/- 4-6 min |
| | 10-12 | | 180°C | +/-11-13 min |
| | 6 | | 180°C | +/- 5-6 min |
| * * * | Nb | | | |
| | | 1,5 Kg | 190°C | +/-13-19 min |
| | | 750 g | 190°C | +/- 7-10 min |
| | | 750 g | 170°C | +/- 8-11 min |
| | | 500 g | 170°C | +/- 4-7 min |
| | 10 p | | 190°C | +/- 5-7 min |
| | | 2 Kg | 190°C | +/- 10-12 min |
| | | 300 g | 190°C | +/- 3-5 min |

