

# Tefal®

## X-FORCE

FLEX 12.60

FLEX 14.60

FLEX 15.60

### INSTRUCTIONS FOR USE



TY98/TY99

Safety Instructions.....	p.3
Troubleshooting .....	p.5
What's in the box .....	p.6
Accessories .....	p.10
Screen .....	p.12
Boost trigger .....	p.13
Storage .....	p.14
How to charge the battery .....	p.15
Charging.....	p.15
Emptying the dust container.....	p.16
Cleaning the filter.....	p.17
Cleaning the motor filter.....	p.18
Cleaning the brush.....	p.19
Do's & Don'ts.....	p.20
Disassembling .....	p.21
Battery disposal .....	p.21

# SAFETY INSTRUCTIONS

Read the safety instructions first before using your product and keep them in a safe place for future reference. For your safety, this appliance complies with all existing standards and regulations .

- This product has been designed for domestic use only. Any commercial use, inappropriate use or failure to comply with the instructions, the manufacturer accepts no responsibility and the guarantee will not apply.
- Read these safety tips carefully. The manufacturer shall not be held liable for improper use or failure to comply with these instructions.
- Your vacuum cleaner is an electrical appliance: it should be used in normal operating conditions.
- Do not use the appliance if it has been dropped and there is visible damage to it, or if it fails to function normally. In this case do not open the appliance, but contact Customer Support or an approved Service Centre.
- Repairs must only be carried out by specialists using original spare parts: it may be dangerous for users to try to repair appliances themselves. Use only guaranteed original spare parts (filters, batteries, etc.).
- Warning: [Use only with – designation – charger]  
WARNING: To recharge the battery, please use only the power unit (charger) and its wall-mount base included with the appliance ( page 15).
- Please remove the battery before discarding it.
- Please ensure that the appliance is unplugged before taking out the battery.
- Please ensure the battery is disposed of safely.
- The external flexible cable or cord of this transformer cannot be replaced; if the cord is damaged or does not work, the transformer shall be scrapped: do not use any detachable power unit (charger) other than the model provided by the manufacturer and contact Customer Support or your nearest approved Service Centre (use of a universal detachable power unit (charger) voids the guarantee)



If the pins of the plug parts are damaged, the plug-in power supply shall be scrapped.

- Never pull the electric cord to disconnect the detachable power unit (charger).
- Always switch off the appliance before maintenance or cleaning.
- Keep hair, loose clothing, fingers, and other body parts away from the appliance's openings and moving parts, especially the rotating brush. Don't direct the tube, the hose or the accessories towards your eyes or ears and keep away from your mouth.
- Always turn off the appliance before connecting or disconnecting the motorised brush.
- Do not touch the rotating parts without stopping and disconnecting the appliance.

- Do not vacuum wet surfaces, water or any type of liquids, hot substances, super smooth substances (plaster, cement, ashes, etc.), large sharp items of debris (glass), hazardous products (solvents, abrasives, etc.), aggressive products (acids, cleaning products, etc.), inflammable and explosive products (oil or alcohol based).
- Never immerse the appliance in water or any other liquid; do not spill water on the appliance and do not store it outside.
- For product start-up, charging, cleaning and maintenance, please refer to the user guide.
- For countries subject to EU regulations (CE marking): This appliance can be used by children aged 8 years and above and persons with reduced physical, sensory or mental capabilities or who lack experience and knowledge if they have been given supervision or instruction concerning safe use and understand the hazards involved. Children should not be allowed to play with the appliance. Children should not clean or perform maintenance on the appliance unless they are supervised by a responsible adult. Keep the appliance and its charger out of the reach of children under 8 years old.
- For other countries not subject to EU regulations: This appliance is not designed for use by people (including children) with reduced physical, sensory or mental capabilities or by people with no prior knowledge or experience, unless they have had supervision or previous instructions relating to the use of the appliance, from a person responsible for their safety. Children must be supervised to ensure that they do not play with the appliance.
- Keep away from children.
- In case of short vacuum breaks, for safety reasons do not place the product in an unstable position (in particular by resting on a wall, on a table or on a chair backrest).
- Store the vacuum cleaner in a secure place (see user's guide). Store the product on its charging base\*.

## Please read before use

- The handheld vacuum cleaner is the base of the product. It can be transformed into a handstick vacuum cleaner by adding the tube and the head.
- Ensure that the voltage indicated on the rating plate of your vacuum cleaner's charger is the same as your power supply voltage. Any connection error could cause irreversible damage to the product and invalidate the guarantee.
- The vacuum cleaner should always be put back on charge after use to ensure that it is always available with a fully charged battery and with optimal performances.
- However, it is best to unplug it in the event of prolonged absence (holidays, etc), in which case, there may be a decrease in autonomy because of self-discharging.

\* depending on model

- Do not vacuum large items that may clog and damage the air inlet.

#### Depending on model:

- Do not use the power-brush on deep pile carpet, animal hair or fringes.
- Switch to „Min/ECO“ to vacuum thick or delicate carpets and rugs and fragile surfaces. Note: check regularly that the nozzle wheels are clean.
- Switch to „BOOST“ for optimum performance on all types of very dirty floors. Note: If the appliance sticks to the surface too much, switch back to „Min/ECO“.
- Do not use your vacuum without a motor protection filter.
- Do not wash the dust collector components or the motor protection filter in a dishwasher.

#### Battery safety instructions

- This unit contains batteries (Lithium Ion) which for safety reasons are only accessible by a professional repairer. When the battery is no longer able to hold the charge, the battery pack (Lithium Ion) should be removed. To replace the batteries, contact your nearest Approved Service Centre. Do not replace a block of rechargeable batteries with non-rechargeable batteries. To change the batteries, please contact an Approved Services Centre.
- The batteries are designed for indoor use only. Never immerse them in water. The batteries must be handled with care. Do not put batteries in your mouth. Do not let batteries touch other metal objects (rings, nails, screws, etc). You must take care not to create short circuits in the batteries by inserting metal objects at their ends. If a short circuit occurs, the battery temperature may rise dangerously and can cause serious burns or even catch fire. If the batteries leak and in case of contact, do not rub your

eyes or any mucous membranes. Wash your hands and rinse your eyes with clean water. If the discomfort persists, consult your doctor.

- WARNING** - The battery used in this appliance may present risk of fire or chemical burn if used incorrectly. It should not be disassembled, short-circuited or stored at < 0°C and > 45°C or incinerated. Keep out of the reach of children. Do not disassemble it or throw it in fire.
- If the appliance is to be stored unused for a long period, the batteries should be removed

#### Environment

In accordance with existing regulation, any end-of-life appliances must be taken to an approved Service Centre which will take responsibility for managing their disposal.

#### Let's help protect the environment.



Your device is designed to work for many years. But when you decide to replace it, don't forget to think about how you can help protect the environment by allowing it to be reused, recycled or recovered in some other way. Waste electrical and electronic equipment may contain harmful substances that can cause harm to the environment and human health. This label indicates that this product must not be disposed of with household waste. Take it to a collection point, to the distributor when buying a new equivalent product, or an approved service center for processing. Before disposing of the device, remove the battery and dispose of it in accordance with local laws and local arrangements. If you have any questions, please contact your product dealer who can tell you what to do.

## PROBLEMS WITH YOUR APPLIANCE ?

Depending on model :

PROBLEMS	POSSIBLE CAUSES	SOLUTIONS
The charger becomes hot.		This is perfectly normal. The vacuum cleaner can remain permanently connected to the charger without any risk.
The charger is connected but your appliance is not charging.	The charger is not properly connected to the appliance or is faulty.	Check that the charger is properly connected or contact an Approved Services Centre to change the charger.

Your appliance stops during operation and the light/s flash very quickly.	Your appliance may be overheating.	Stop the appliance and leave cool for at least 1 hour.
The appliance has stopped after the charge light flashed.	The appliance has lost its charge.	Recharge the vacuum cleaner.
The power-brush is not working properly or makes a noise.	The rotating brush or hose are obstructed.	Stop the vacuum and clean the parts.
	The brush is worn.	Contact an Approved Service Centre to change the brush.
	The belt is worn.	Contact an Approved Service Centre to change the belt.
The power-brush stops during use of the vacuum cleaner.	The heat safety device has come on.	Stop the vacuum cleaner. Check that nothing is obstructing the rotation of the brush; if there is an obstruction, remove it and clean the power-brush, then turn on the vacuum cleaner.
Your vacuum cleaner suction is not working properly or is making a whistling noise.	The tube or hose is partially blocked.	Unblock them the tube/hose.
	The dust collector is full.	Empty it and clean it.
	The dust collector is not properly fitted.	Re-position it correctly.
	The suction head is dirty.	Remove the power-brush and clean it.
	The foam motor protection filter is full.	Clean it.
When charging the vacuum cleaner, the light(s) flash very quickly or the red light is on.	The correct charger is not being used or the charger is faulty.	Talk to an Approved Service Centre to change the charger.
The red LED on the product flashes during use	The suction head brush is blocked.	Stop vacuuming and check that there is nothing blocking the rotation of the brush.
	The battery temperature is too high.	Leave the product to rest for 30 minutes. If the problem persists, replace the battery.
	The tube and/or suction head connectors are dirty or damaged.	Clean the tube and suction head connectors with a cloth.
	The suction motor is not working.	Contact an Approved Service Centre to have your appliance repaired.
The vacuum feels very stiff/difficult to push on carpet.	The vacuum is being used on a very deep/long pile carpet.	Reduce the suction power using the control panel to make it easier to push the vacuum on long pile carpet. If this doesn't work, revert to using a non motorised accessory such as the sofa brush/crevice nozzle.

Please keep this user manual.

CHARGER		
Reference	Country	Reference
TY99	UK/ROI	SS-2230003050
TY98	UK/ROI	SS-2230002785

BATTERIES		
Reference	Voltage	Reference
TY99	32.4VDC	ZR009702/SS-2230002599 / SS-2230002598
TY99	33.3V	SS-2230002589
TY98	25.9VDC	ZR009705/SS-2230002965



## WHAT'S IN THE BOX

- 1 **EASY WASH FILTER** - Added layer of filtration to enhance the performance of your cordless vacuum cleaner. An extra filter is added in the box.
- 2 **SEPARATOR** - First step of filtration, creates cyclonic force to separate air from dirt.
- 3 **DUST CONTAINER** - XL dust container, up to 0.9L, designed for large surfaces & less emptying. Easy to access, empty & clean.
- 4 **LED LIGHTS** - For increased comfort and spotless cleaning even in dimly lit areas.
- 5 **FINE PARTICLES FILTER** - Captures fine particles and releases purified air.
- 6 **REMOVABLE BATTERY** - The removable battery ensures constant suction power.
- 7 **CHARGING BASE** - Charging base to easily charge & store your appliance as well as your accessories.
- 8 **CREVICE NOZZLE** - Designed to help you collect dirt in hard to reach or tight spaces.
- 9 **SOFA BRUSH** - Additional tool to vacuum your textiles such as armchairs, curtains, or mattresses.
- 10 **INTEGRATED DUST BRUSHES** - Allows you to clean the majority of your surfaces
- 11\* **STORAGE BAG**
- 12\* **DOCKING STATION** - Allows the device to be stored and plugged in simultaneously
- 13\* **MINI FLEX** - Clean as far and effortlessly as possible under your low furniture
- 14\* **ANIMAL TURBO BRUSH** - Removes fur, hair & dirt especially for you pet owners.



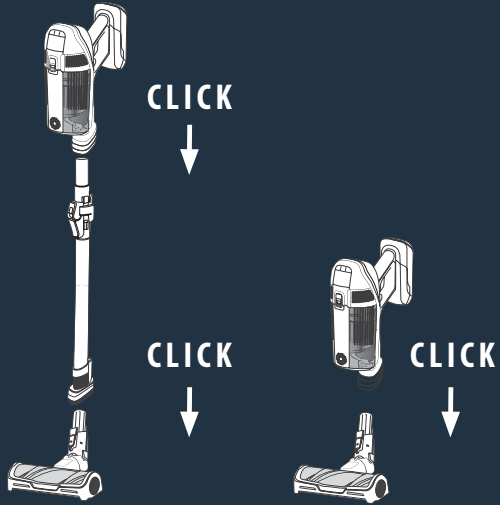

## USAGE TIMES

		12.60			14.60				15.60			
		Eco	Max	Boost	Eco	Eco+	Max	Boost	Eco	Eco+	Max	Boost
	Up to	45 min	23 min	05 min	70 min	29 min	11 min	05 min	80 min	34 min	12 min	05 min
When used in handheld mode, without motorised accessory												
		35 min	20 min	05 min	63 min	28 min	10 min	05 min	67 min	32 min	12 min	05 min
When used with motorised accessory												



Use the flex technology to clean under tables, beds & furniture. To activate, push the unlock latch, located behind the main tube of your vacuum. To revert to upright mode, simply straighten the angle of the tube until it clicks back into place.



## ACCESSORIES



The crevice nozzle is perfect for getting into small spaces & corners



The mini flex can be used to vacuum with more precision on areas difficult to reach



The animal turbo brush cleans deeply, perfect for vacuuming pet hair.



Use the sofa brush to vacuum your textiles such as armchairs, curtains, or mattresses.



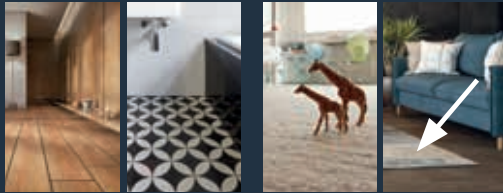

When your vacuum detects hard floors, it will automatically adjust to ECO/ECO+ mode.

When your vacuum detects carpets and rugs, it will automatically adjust to MAX mode

Eco - Eco +

Max

% ↔ min



Auto

Your vacuum automatically detects the type of floors being vacuumed, automatically adjusting the power level to give you the best cleaning results, without using more power than needed.

**PLEASE NOTE:**  
If you are vacuuming on long pile carpets, you may need to manually decrease speed to eco mode as the brush might resist or stop to protect the floors.



F = Cleaning Filter alert

The clean filter alert reminds you when to wash your filter. Maintaining a clean filter allows your cordless handstick to deliver excellent results day after day.



ON / OFF

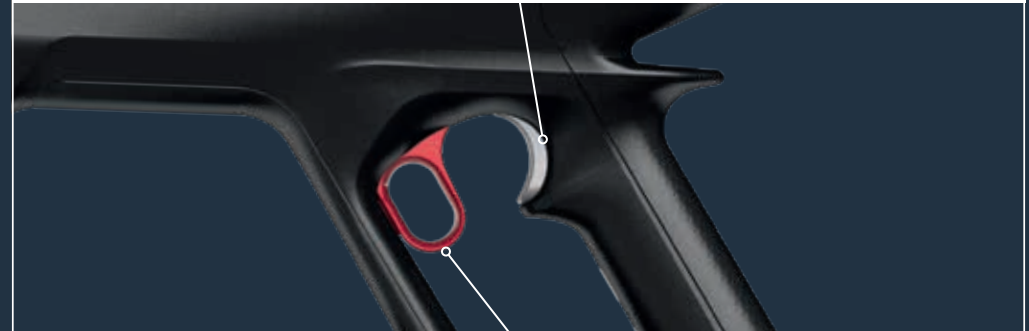

BOOST



Boost trigger for extra cleaning power when needed

With Tefal's patented Boost trigger, you can now enjoy maximum power at your fingertips : Pull the trigger to get a shot of power whenever you need extra performance!  
Exceptional performance - Powerful suction for messes big and small.  
An integrated resistance sensor is designed to stop the motorized brush to protect your floors (ex. long pile carpets). If resistance is too high/ brush stops, restart your product and decrease power level (Eco speed) to facilitate vacuuming.



## STORAGE

Each model in the X FORCE range comes with a storage solution so that you can safely store your vacuum when not in use.

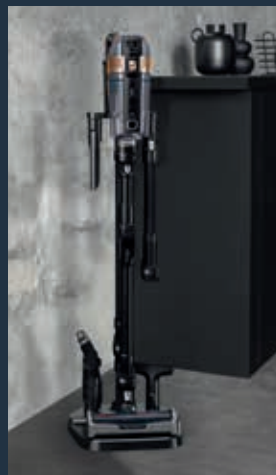
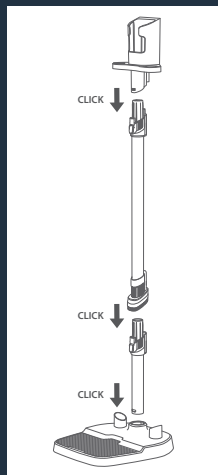
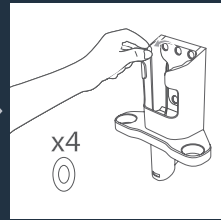
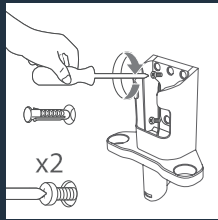
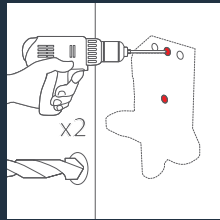
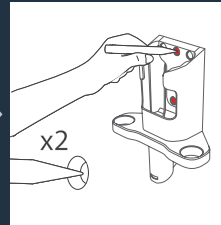
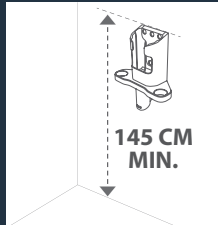
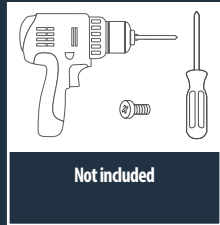

## HOW TO CHARGE THE BATTERY



To charge the battery, it must be removed from the handle

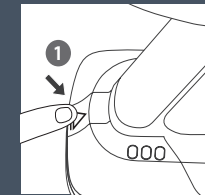

Grip the handle with one hand and use your other hand to firmly press on the battery release switch

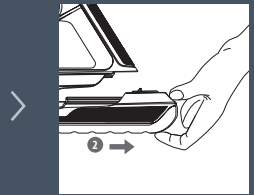

Slide out the battery

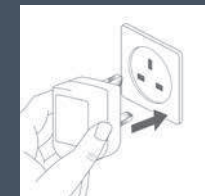

Connect the battery into the mains adapter to charge



## CHARGING

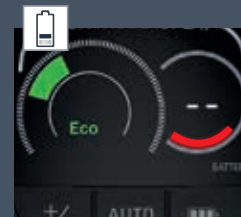

The intelligent handle on your vacuum will show the level of battery power remaining. When you need to charge, follow the instructions below.



A full charge takes approximately 3 hours. During charging, the indicator light on the battery will flash.

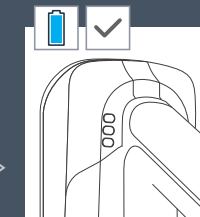

When charging is complete, all 3 lights on the battery will remain solid

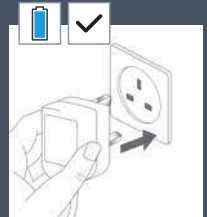

Use the charging adapter included with your vacuum for charging





## EMPTYING THE DUST CONTAINER



## CLEANING THE FILTER



CLEAN 1X/WEEK

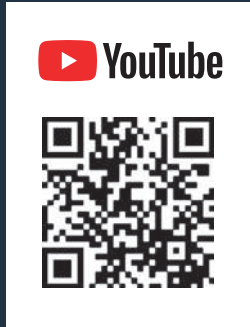

For best results, empty the dust container when it is full



Slide the switch on the handle upwards, and lift away the dust container



Slide the switch on the handle upwards, and lift away the dust container



Remove the separator.

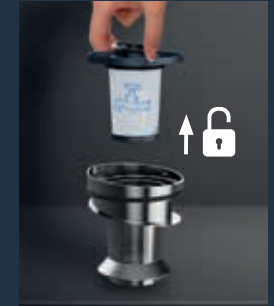

Turn to unlock the filter and lift out.



Remove the separator.



Empty contents into a bin



Replace the separator by twisting until it drops into position inside the dust container



Rinse the dust container under the tap

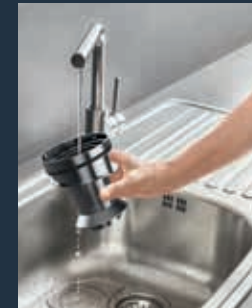

Rinse the filter under the tap

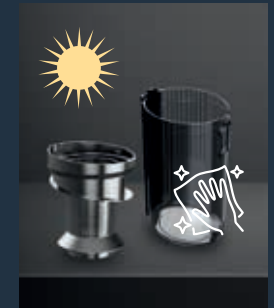

Allow to dry thoroughly. This is very important and make take up to 72 hours. Consider using the spare filter during this time to allow the filter to thoroughly dry.



Locate the slot on the container base, onto the lip on the handle. Lever the container back into position until you hear a click.



Replace the filter back into the separator and twist to lock into position



Replace the separator, twisting until it drops into position inside the dust container.

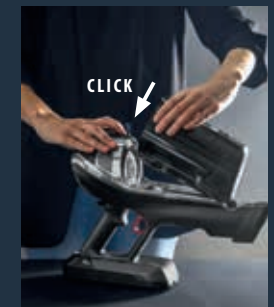

Locate the slot on the container base, onto the lip on the handle. Lever the container back into position until you hear a click.

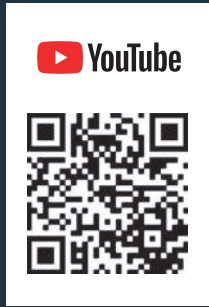

CLEAN 1X/WEEK



# CLEANING THE BRUSH



CLEAN 1X/WEEK



REPLACE 2X/YEAR



# CLEANING THE MOTOR FILTER

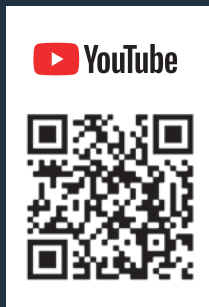

WASH 2X/YEAR

There is a second filter in your vacuum cleaner which needs to be cleaned 2 times per year

Rinse thoroughly

Let it dry completely for at least 24 hours before re-installing.



REPLACE 1X/YEAR

Firstly remove the dust container (see previous section). Then slide the switch on the handheld unit upwards, and pull firmly on the fine particles filter to remove it

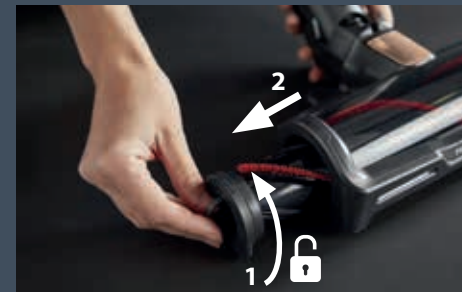

Slide out the brush

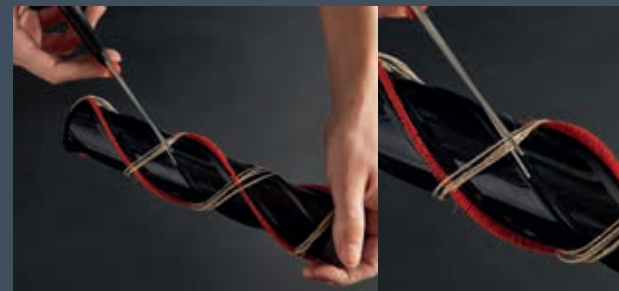

Use scissors to carefully cut loose any hair wrapped around the brush

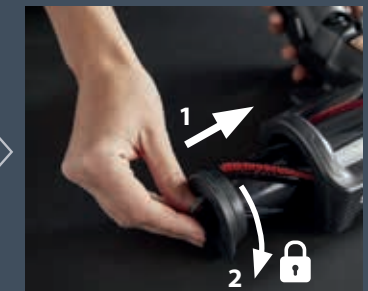

Slide the brush roll back into the head and twist to lock back into position

\* Not included



# DO'S & DON'TS

## STANDING OR STORAGE POSITION

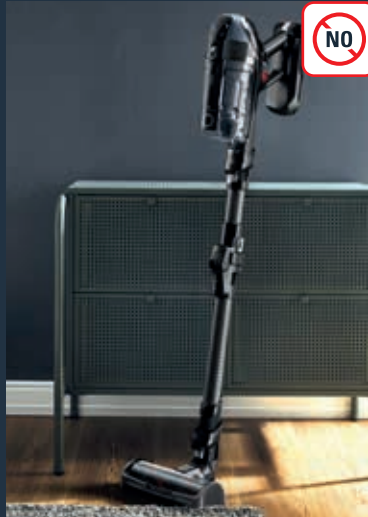

Always store the unit in the storage solution provided. The unit is not designed to stand up on its own

\* Depending on model



# DISASSEMBLING

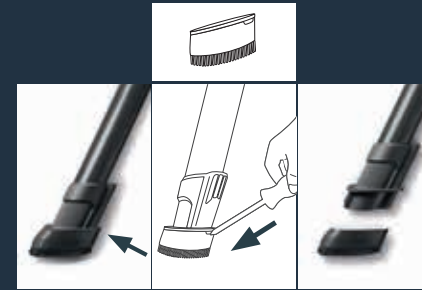

To remove the dust brush, insert a pointed object into the hole on the back of the brush to lift and unclip the brush.

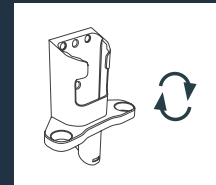
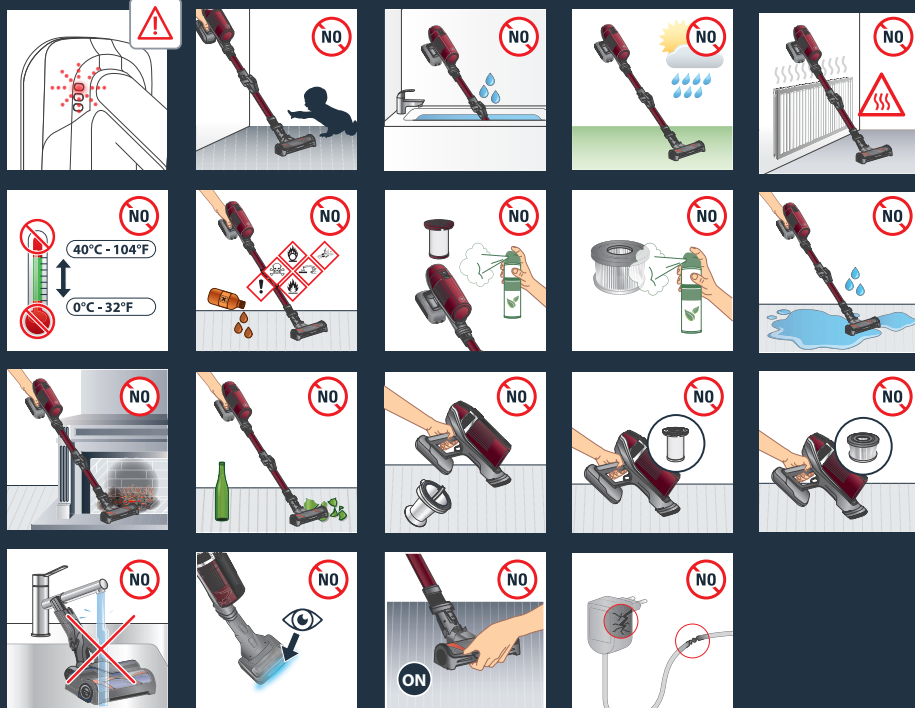

To separate the accessories' holder from the storing base, first turn it upside down

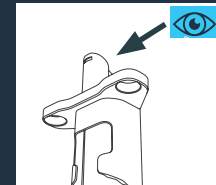

Look for the hole on the bottom of the base

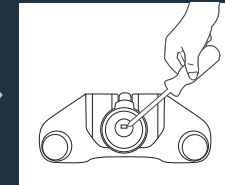

Insert a pointed object into the hole to unclip the lower part of the storing base

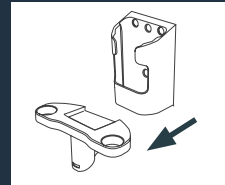

Remove the accessories' holder from the storing base



# BATTERY DISPOSAL

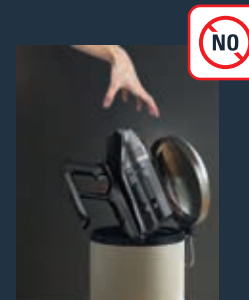





**FOR MORE INFORMATION**

[www.tefal.com](http://www.tefal.com)

2220006399/02 – 01/24