

Tefal®

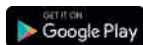

From Android™ 4.3 with
Bluetooth low energy (BT4.0)



iPhone 4S or newer model.
iPad 3/iPad mini or newer model.



See side
for compatibility 

Check the compatibility of your device with
ActiFry® smart on www.actifrysmart.com
Direct access via QR code



ActiFry smart XL

www.tefal.com

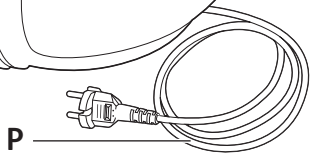
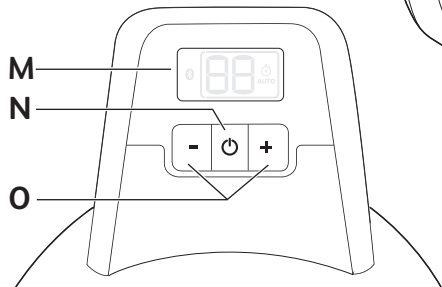
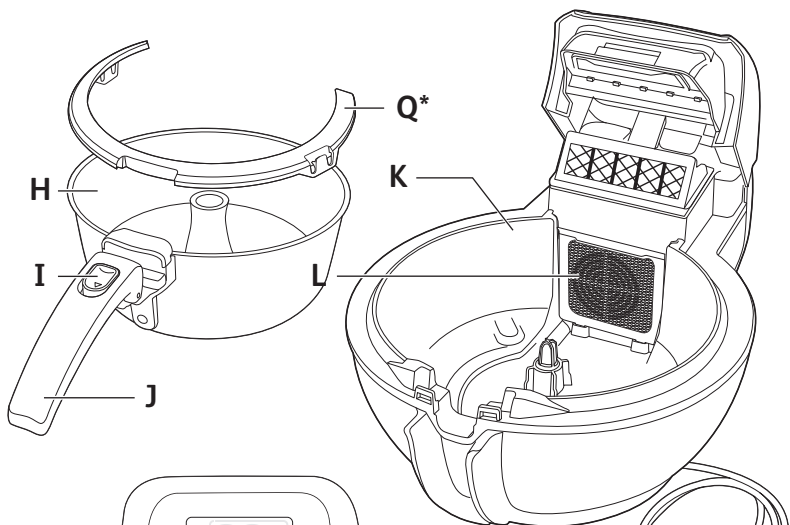
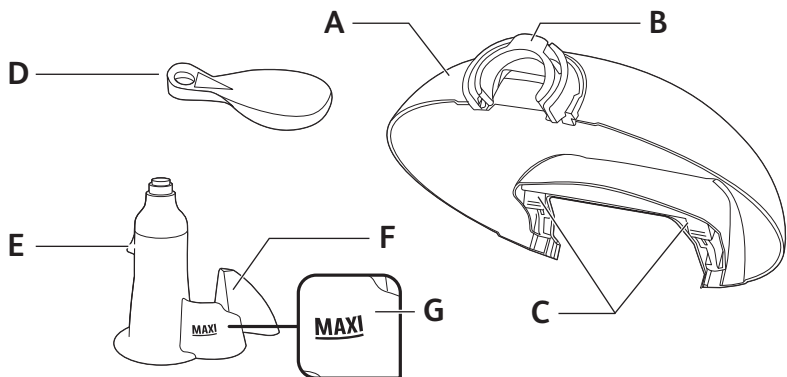

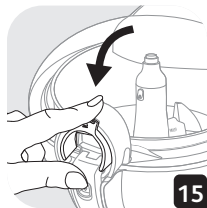
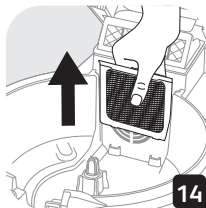
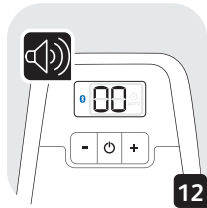
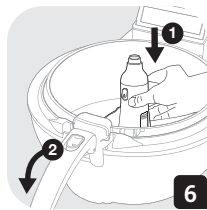
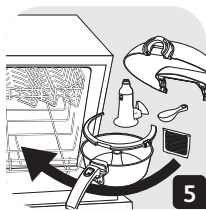
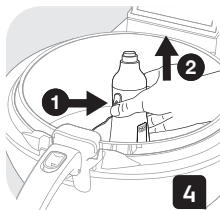
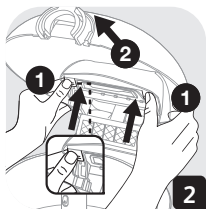
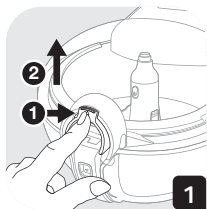

Important recommendations

Safety instructions

- This appliance has been designed for indoor domestic use only; any professional use, inappropriate use or failure to comply with the instructions will release the manufacturer from all responsibility and the guarantee will be deemed null and void.
- Read these instructions carefully and keep them in a safe place.
- This appliance is intended for domestic use only.
- This appliance is not intended to be operated using an external timer or separate remote control system, other than those specified by the manufacturer, such as a smartphone or tablet.
- Do not use the appliance if it or the power cord is damaged or if it has fallen and has visible damage or appears to be working abnormally. If this occurs, the appliance must be sent to an Approved Service Centre.
- If the power cord is damaged, it must be replaced by the manufacturer, an approved After-Sales Service or a similarly qualified person, in order to avoid any danger. Never take the appliance apart yourself.

- This appliance is not designed to be used by people (including children) with a physical, sensory or mental impairment, or people without knowledge or experience, unless they are supervised or given prior instructions concerning the use of the appliance by someone responsible for their safety. Children must be supervised to ensure that they do not play with the appliance.
- This appliance can be used by children aged from 8 years and above and persons with reduced physical, sensory or mental capabilities or lack of experience and knowledge if they have been given supervision or instruction concerning use of the appliance in a safe way and understand the hazards involved. Children shall not play with the appliance. Children under the age of 8 years should not use this appliance unless continuous supervision by a responsible adult is given. Cleaning and user maintenance shall not be made by children unless they are older than 8 years and supervised. Keep the appliance and its cord out of reach of children less than 8 years.
-  Certain parts of the appliance can become hot when the appliance is operating, which could cause burns. Do not touch the hot surfaces of the appliance (the lid, visible metal parts, etc).

- All these removable parts may be cleaned in the dishwasher or with a non-abrasive sponge and washing up liquid.
- Clean the body of the appliance with a damp sponge and washing up liquid.
- Dry the parts carefully before reassembling.
- Children should not clean or perform maintenance procedures on the appliance unless they are supervised by a responsible adult.
- Do not use the appliance close to inflammable materials (blinds, curtains, etc), nor close to an external heat source (gas hob, hotplate, etc).
- This appliance is intended to be used only in the household. It is not intended to be used in the following applications, and the guarantee will not apply for:
 - staff kitchen areas in shops, offices and other working environments;
 - farm houses inns,
 - clients in hotels, motels and other residential type environments,
 - bed and breakfast type environments.
- Do not immerse the product in water or any other liquid.
- Never operate the appliance using the removable cooking pan only and without the mixing blade or the appropriate ACTIFRY accessory.

- For your safety, this appliance conforms with applicable standards and regulations (Directives on Low Voltage, Electromagnetic Compatibility, Materials in contact with food, Environment, etc.).
- Check that the voltage of your mains network corresponds to the voltage given on the rating plate on the appliance (alternating current).
- Given that there are so many different standards, if the appliance is to be used in a country other than that in which it was bought, have it checked by Approved Service Centre.
- For models with detachable power cords, only use the original power cord.
- Do not use an extension lead. If you nevertheless decide to do so, under your own responsibility, use an extension lead that is in good condition and compliant with the power of the appliance.
- Use the appliance on a flat, stable, heat-resistant work surface away from water splashes.
- Do not let the power cord dangle.
- Do not unplug the appliance by pulling on the power cord.
- The power cord must never be close to or in contact with hot parts of the appliance, close to a source of heat or resting on sharp edges.
- Always unplug your appliance: after use, to move it, or to clean it.
- In the event of fire, unplug the appliance and smother the flames using a damp tea towel.
- Never operate the appliance underneath kitchen cupboards.
- Never move the appliance when it still contains hot food.
- Never operate your appliance when empty.
- Never leave the appliance unattended whilst it is plugged in and switched on.
- When using the product for the first time, it may release a non-toxic odour. This will not affect use and will disappear rapidly.
- Do not overload the cooking pan; stick to the recommended quantities.
- **USING THE TURN-OVER RING.** Your appliance is equipped with an automatic turn-over ring (depending on model). This turn-over ring should be used to cook chips. We also recommend using it for recipes that require a large quantity of food. Remove the turn-over ring for liquid recipes, for ease of pouring at the end of cooking.
- **To avoid damaging your appliance, please ensure that you follow the recipes in the instructions or ActiFry® app; make sure that you use the right amount of ingredients.**

Protect the environment

- When you decide to replace the appliance, remember to think about how you can contribute to protecting the environment.
- Before discarding your appliance you should remove the battery from the timer and dispose of it at a local civic waste collection centre (according to model).
- The Approved Service Centres will take back any old appliances you may have so that they can be disposed of in accordance with environmental regulations.

Environment protection first !



① Your appliance contains valuable materials which can be recovered or recycled.

➔ Leave it at a local civic waste collection point.

PRECAUTIONS

- Do not turn on the appliance when it is empty.
- Do not overload the cooking pan, keep to the recommended quantities.
- During its first use, the appliance may give off a harmless odour. They will not affect use and will disappear rapidly.
- To avoid damaging your appliance, please stick to the quantities of ingredients and liquids provided in the user guide and recipes.
- For liquid recipes, never exceed the maximum level indicated on the removable paddle.
- Never leave the measuring spoon in the removable cooking pan when the appliance is operating.

DESCRIPTION

- | | |
|---|---|
| A. Transparent lid | J. Cooking pan handle |
| B. Lid opening button | K. Body |
| C. Lid release catch (x2) | L. Removable filter |
| D. Measuring spoon | M. LCD interface |
| E. Paddle release button | N. Cooking start and stop button |
| F. Removable mixing paddle | O. +/- Timer setting button (in minutes) |
| G. Maximum capacity for liquids only | P. Fixed power cord |
| H. Removable cooking pan | Q. Removable turn-over ring (* depending on model) |
| I. Handle release button | |

BEFORE FIRST USE

- Remove all the stickers and any packaging.
- Open the lid by pressing on the lid opening button - fig.1 and press the catches to remove the lid - fig.2.
- Remove measuring spoon.
- Lift the pan handle to a horizontal position until you hear a "CLICK" as it locks before removing the pan - fig.3.
- To remove the turn-over ring, pull the clips outwards, then lift it off.
- Remove the paddle by pushing the release button - fig.4.
- Take out the removable filter - fig.14.
- All removable parts are dishwasher safe - fig.5 or may be cleaned with a soft sponge and washing up liquid.
- Clean the body of the appliance with a damp cloth and washing-up liquid.
- Never immerse the base in water.
- Dry carefully before putting everything back in its place.
- Reposition the paddle until you hear a "CLICK" - fig.6.
- To replace the turn-over ring, place it at the edge of the pan, centre it on the pan and press down until you hear a "CLICK".
- On first use, to obtain the best results from your new product, we advise you to prepare a recipe that cooks for 30 minutes or more.





Check that your appliance is compatible with ActiFry® Smart at www.actifrysmart.com
Direct access via QR code



Appliance activation

- Activate the Bluetooth® function on your tablet or smartphone.
- Download the MyActiFry® app from the App Store or Play Store for Android™ via your tablet or smartphone.
- Open the MyActiFry® app - fig.7.

IMPORTANT: *the initial installation may take several minutes depending on the quality of your connection and the time needed for the app to download all recipes and associated media.*

- Connect the power supply cable to an electrical socket. The appliance will beep twice and the screen will display 00.
- A product identification page will appear. Select ActiFry® Smart XL.
- The first time you connect, you should stand near the appliance with your tablet or smartphone. Launch the app by clicking on the MyActiFry® icon. Select ActiFry® Smart XL. The app will then search for your ActiFry® Smart XL - fig.8. Click the appliance's  button when you see the flashing  symbols.

To finalise the pairing, follow the instructions below:

For IOS

Confirm the pairing request via the message that appears on your iOS smartphone or tablet by pressing on the Pairing button.

For Android™:

Depending on your model of Android™ smartphone or tablet, one of 3 types of messages may appear:

- a. **Automatic pairing:** no need to confirm.
- b. The message « **Bluetooth® pairing request** » will be displayed on your screen. Simply click on "CONNECT". There's no need to enter a pairing code .
- c. **A notification will appear at the top of your screen:** Slide the screen downwards, then click on this notification to display the "Bluetooth® pairing request" message.
Click on "CONNECT". There's no need to enter the pairing code.
- d. A final message will confirm that pairing was successful. Your ActiFry® Smart XL is now connected.

- The Bluetooth® logo appears , so your appliances are now connected.
- Once connected, you can access the nutrition coach by creating your account. You can use this account to access a large number of recipes.
- Your ActiFry® Smart XL is working.
- Access the world of ActiFry® Smart XL recipes by selecting "recipes" from the menu.
- Choose your recipe, either by using the search bar or by using the filters in the "recipes" tab.

Cooking

Do not exceed the maximum quantity of food - fig.10. (also see recipes) and in addition for liquid recipes do not exceed the maximum level mark on the paddle - fig.11. Do not leave the measuring spoon inside the pan when cooking food.

• Start cooking from the app and follow the instructions:



• Either follow step by step. To be guided through your recipes.



• Or go straight to your cooking step directly if you already know what you're doing.

NB:





• Recipes displaying the  icon guarantee the best cooking results and greatest simplicity in terms of preparation.

When you start cooking, your application sends all the parameters (temperature adjustment, paddle rotation variation, adjusted cooking time) to your ActiFry® Smart XL to ensure your recipes are successful every time and wow your friends and family!

The expertise of a chef for tastier and simple to prepare recipes!

If your app is connected to your ActiFry® Smart XL:

- During cooking, you can adjust the cooking time directly from the app or on the appliance using the "+" and "-" keys.
- During cooking, you can pause the appliance, either from the app or on the appliance itself.
 - When using the app, press "pause" or "stop"
 - On the appliance, you simply have to lift the lid or press the  key
- To restart cooking, close the lid and press on your appliance's  key or on "restart" from the app.
- When left open for over 2 minutes, the appliance will reset.

Important:



- You can take control again using the appliance directly at any time.
- When the lid is opened, the Bluetooth® connection will be interrupted and the app will disconnect. The  logo flashes and searches for the ActiFry® for 5 min.
- In any event, ensure that you never leave the appliance unattended whilst in operation.

Remove the food

- When cooking is complete, the timer sounds, the screen displays 00 - fig.12, and a window displays in the app - fig.13 : The appliance stops cooking your recipe automatically.
- Turn off the timer by pressing on one of the "+" or "-" buttons.
- Open the lid- fig.1.
- Lift the handle until you hear a "CLICK" to remove the cooking pan and take out the food.

COOKING WITHOUT CONNECTION

Start cooking

- Open the lid - fig.1
- Place the food in the cooking pan and do not exceed the maximum quantity - fig.10 (see recipes) and the Maxi level mark on the paddle for liquid recipes- fig.11
- Prepare your ingredients as indicated in the recipe (book, app). Place your ingredients into the cooking pan as per the instructions in your recipe.
- Release the handle and lower it fully into its housing - fig.3
- Close the lid.
- Connect the power supply cord to an electrical socket. The appliance will beep twice and the screen will display 00.
- Set the cooking time using the + and - button (see recipe instructions) and press the  button. The appliance will once again beep twice and cooking will begin.
- The selected time will be displayed and a minute by minute countdown will begin. Time is selected and displayed in minutes. Only time remaining under 1 minute will be displayed in seconds.
- The appliance can be paused. All you have to do is press the  key. Pressing this key a second time will restart cooking.
- You can adjust the time at any point during cooking using the + and - keys.
- If you make a mistake or would like to cancel the selected time, hold down the button for at least 2 seconds and then reset the time..

Remove the food

- When the lid is opened, the appliance will turn off. To restart cooking, close the lid and press the  key of your appliance.
- When the lid is left open for over 2 minutes, the appliance will reset.
- When cooking is complete, the timer sounds, the screen displays 00 - fig.12, and a window displays in the app - fig.13. The appliance stops cooking your recipe automatically. Turn off the timer by pressing on either of the "+" or "-" buttons..
- Open the lid - fig.1.
- Lift the handle until you hear a "CLICK" to remove the cooking pan and take out the food.
- Do not use metal utensils in the cooking pan or when serving food.

CLEANING THE APPLIANCE

- Never immerse the base in water.
- Do not use harsh or abrasive cleaning products or scourers.
- The removable filter must be cleaned regularly.
- Leave it to cool down completely before cleaning.
- Open the lid by pressing on the lid opening button - fig.1 and press the catches to remove the lid - fig.2.
- Lift the pan handle to a horizontal position until you hear a "CLICK" as it locks before removing the

- pan - fig.3.
- Remove the paddle by pushing the unlock button - fig.4.
- To remove the turn-over ring, pull the clips outwards, then lift it off.
- Take out the removable filter - fig.14.
- All removable parts are dishwasher safe - fig.5 or may be cleaned with a soft sponge and washing up liquid.
- Clean the body of the appliance with a damp cloth and washing-up liquid.
- Clean the removable lid after each use to prevent a build up of residues.
- Dry carefully before putting everything back in its place.
- Reposition the paddle until you hear a "CLICK" - fig.6.
- To replace the turn-over ring, place it at the edge of the cooking pan, centre it on the cooking pan and press down until you hear a "CLICK".

TROUBLESHOOTING TIPS

- If you cannot connect with the app, make sure you have correctly chosen ActiFry® Smart XL. To do so, go to my account, MyActiFry®. If you haven't already done so, select ActiFry® Smart XL.
- The user can force reconnection by pressing on the icon; 
- In gourmet mode, the paddle may occasionally stop working. This is perfectly normal.
- If Er.7 is displayed, this means a Bluetooth® error has occurred. Please take the appliance to an authorised Service Centre.
- If you encounter any difficulties or have any questions, a FAQ is available on the app in the "guide" section.

ACTIFRY COOKING HINTS AND TIPS

- Do not add salt to chips while the chips are in the pan. Only add salt once the chips are removed from the appliance at the end of cooking.
- When adding dried herbs and spices to Actifry, mix them with some oil or liquid. If you try sprinkling them directly into the pan they will just get blown around by the hot air system.
- Please note that strong coloured spices may slightly stain the paddle and parts of the appliance. This is normal.
- For best results, use finely chopped garlic instead of crushed garlic to avoid it adhering to the central paddle.
- If using onions in ActiFry recipes, they are best thinly sliced instead of chopped as they cook better. Separate the onion rings before adding them to the pan and give them a quick stir so that they are evenly distributed.
- With meat and poultry dishes, stop the appliance and stir the pan once or twice during cooking so that the food on top does not dry out and the dish thickens evenly.
- Prepare vegetables in small pieces or stir fry size to ensure they cook through.
- This appliance is not suitable for recipes with a high-liquid content (eg. soups, cook-in sauces...).

- For best results, the best place to store potatoes is in a dark cellar or cool cupboard (between 6 and 8°C), away from the light.
 - Remember that there can be seasonal variations in the quality of potatoes used, even for the varieties of potato we recommend (Rooster, Maris Piper or King Edwards) these can also be affected by the weather ie long, wet summers will produce potatoes with a higher water content than normal which may produce less crisp results. If this happens, try changing the potatoes you are using.
 - The way the potatoes are stored in Supermarkets can also affect the cooking result. Try buying potatoes from a different supermarket or source.
 - The chips must be perfectly dry before putting them in the pan otherwise they will not turn crispy. Wipe off any excess ice from frozen chips.
 - With Actifry, you can use a very wide variety of oils:
 - Standard oils : olive oil, grape seed oil, corn oil, groundnut (peanut) oil, sunflower oil, soya oil*
 - Flavoured oils : oils infused with aromatic herbs, garlic, chilli, lemon...
 - Speciality oils : hazelnut*, sesame*...
- (*cook according to the manufacturers instructions)

Timer battery

This appliance uses a button battery – L1154.

- To change the battery remove the control panel with a small flat bladed jewellers screw driver. Prise the control panel up by inserting the screwdriver into the gap at the top of the panel. Remove the white battery cover and replace the battery To protect the environment do not throw the old battery in your regular waste but take it to a suitable collection point.
- Insert a new battery, put the battery cover back on and clip the control panel back on.

